

Phase II (Small) MS4 Annual Report Form

TPDES General Permit Number TXR040000

A. General Information

Authorization Number: TXR040368 Annual Reporting Year: (calendar year, permit year, or fiscal year): 3 day of fiscal year, if applicable: 12/13/15 - 12/12/16
 MS4 Operator Level: Phase II Name of MS4/Permittee: City of Texarkana
 Contact Name: Laura Puckett Telephone Number: (903 798-3948)
 Mailing Address: P.O. Box 1967/220 Texas Blvd., Texarkana, TX 75504
 E-mail Address: laura.puckett@txkusa.org

B. Narrative Provisions (Part IV Section B.2.(a))

1. Provide information on the status of complying with permit conditions:(Part V - Standard Permit Conditions):

	Yes	No	Explain
Permittee is currently in compliance with the SWMP as submitted to and approved by the TCEQ.	X		
Permittee is currently in compliance with recordkeeping and reporting requirements.	X		
Permittee meets the eligibility requirements of the permit (e.g., TMDL requirements, Edwards Aquifer limitations, compliance history, etc.)	X		

2. Provide a general assessment of the appropriateness of the selected BMPs. Use table below or attach a summary, as appropriate (See Example 1 in instructions):

MCM(s)	BMP	BMP is appropriate for reducing the discharge of pollutants in stormwater (yes or no). Explain.
The City reviewed the BMPs listed in the SWMP and has determined that all selected BMPs are appropriate to date. Based on eight years of BMP implementation, City staff believes that the BMPs selected are appropriate to meet the conditions of the general permit. As required, Texarkana will assess the selected BMP appropriateness each year, and if it is determined that any BMP(s) proves ineffective it will be replaced or modified according to the results of the assessment.		

3. Describe progress towards reducing the discharge of pollutants to the maximum extent practicable. Summarize any information used (such as monitoring data) to evaluate reductions in the discharge of pollutants. Use a table or attach a narrative description as appropriate:

M C M	BMP	Parameter	Quantity	Units	Does BMP Demonstrate a Direct Reduction in Pollutants? (Yes / No / Explain)
1	Public Education	Utility Bill	43,737	Message on the bill	No. This message does not directly impact the reduction of pollutants into the MS4. However, the message does educate the public on ways to reduce the pollutants they put into the MS4 and eventually should reduce the production of pollutants into the MS4.
1	Public Education	Adopt-A-Spot	9	Web page on City Website	Yes. This program does directly impact the reduction of pollutants into the MS4. Each voluntary group picks up debris from the adopted roadway thus eliminating the pollutants that enter the MS4.
1	Public Education	School Message	1,500	School book covers	No. This message does not directly impact the reduction of pollutants entering into the MS4. However, the message will educate the younger generation on the proper disposal of pollutants. Therefore, eventually the message will impact the reductions of pollutants into the MS4. Also, Provided "Discover Flood" books for educational purposes to the Parks and Recreation department to educate children on flooding.

1	Public Education	Businesses, Commercial and Industrial Activity	160	Brochures	No. The message in the brochure does not directly impact the reduction of pollutants entering the MS4. However, the brochure does help the businesses and commercial and industrial community on how they can reduce pollutants entering into the MS4.
1	Public Education	Television Message	1	Flyer	No. The flyer does not directly reduce the pollutants entering into the MS4. It does however, illustrate proper ways the public can reduce pollutants from entering the MS4.
1	Public Education	Links on Website	1	Stormwater Management Link	No. The links do not directly impact the reduction of pollutants. It can provide the knowledge to reduce pollutants in the future.
1	Public Education	PSA	1	Stormwater PSA – Movies in the Park	Prepare a Public Service Announcement to play before movies in the park.
2	Illicit Discharge Detection and Elimination	Visual Inspection of Selected Stormwater Outfalls During Dry Weather	5	Visual Dry Weather Inspections	Yes. Visual inspections will impact the reduction of pollutants that enter into the MS4. Visual inspections were completed.
2	Illicit Discharge Detection and Elimination	Development of Storm Sewer Map	1	Map Data	No. However, this information will help staff to locate outfalls and pinpoint any possible area of pollutants.
2	Illicit Discharge Detection and Elimination	Educate	Annually	Training	Yes. Training on illegal discharges to the Stormwater System helps immediately eliminate any problematic discharges.

3	Construction Site Runoff Controls	Implement and Maintain Ordinance and Enforcement	37	Require and Review of submitted SWPPPs Applications and Erosion Control Plans	Yes. Reviewing the required documents do impact the reduction of pollutants that enter into the MS4. The process allows immediate corrections to any possible problems that might occur.
3	Construction Site Runoff Controls	Develop Inspection Procedures	Periodically	Training	Yes. The development of inspection procedures and training inspectors do impact the reduction of pollutants into the MS4. The inspectors have the ability to immediately change a problem or the discharge of possible pollutants.
3	Construction Site Runoff Controls	TXDOT Stormwater Field Inspector's Guide notebook	1	Notebooks (2)	No. However, the notebook is a guideline for the inspector to help with the reduction of possible pollutant discharges on municipal projects.
3	Construction Site Runoff Controls	Implement Mechanism for Contractor Comment	4	Hotline, Verbal, Written, and meetings	Yes. Immediate help is provided to comments or questions from contractors and can address immediate concerns of illicit discharges.
4	Post Construction Stormwater Management New Development and Redevelopment	Create Written Education Materials for Area Developers regarding Post Construction Controls	160	Brochures	No. The brochure does not directly impact the reduction of pollutants entering the MS4. However, the brochure does help the developer's on how they can reduce pollutants entering into the MS4.

4	Implement and refine a Long-Term Operation Maintenance Program for Post Construction Existing Stormwater Controls	Create Mechanism to ensure that maintenance is addressed	Monthly	Schedule regular inspections and maintenance and notify owners of stormwater controls	Yes. The inspections can immediately reduce pollutants by stopping the possible discharge at each site.
5	Pollution prevention/Good Housekeeping for Municipal Operations	Assess municipal Properties	Periodically	Inspection, checklist, and findings	Yes. The inspections can immediately correct illicit discharges to the MS4.
5	Pollution prevention/Good Housekeeping for Municipal Operations	Train City Employees	Periodically	Inspections	Yes. The Employees receive on-site experience and training during municipal inspections and can reduce the possible illicit discharge to the MS4 at that time and/or provide the proper disposal of discharge. With training the employees also can detect possible discharges in the future.
5	Pollution prevention/Good Housekeeping for Municipal Operations	Policy and Procedure	Periodic	Inspections	Yes. The policy and procedures provide guidelines to prevent any illicit discharge.
5	Pollution prevention/Good Housekeeping for Municipal Operations	Implement a Work Order System	Continual	Schedule regular clean ups	Yes. The city has purchased a work order system to help with daily scheduling of cleaning right of ways, clean-up and regrading of drainage ditches, and inlet cleanings. The clean-up of drainage ditches and inlet cleaning reduces pollution to the MS4 and the regrading of ditches allows the stormwater to flow properly. This system allows us to keep a history of all the work order completions. The crew works each work order on a daily basis.

5	Pollution prevention/Good Housekeeping for Municipal Operations	Implement Wash bay policy at Fleet Services	Continual	Regular	Prepared and provided supplies for all city vehicles to be cleaned in the wash bay at fleet services.
5	Pollution prevention/Good Housekeeping for Municipal Operations	Create Positions	Continual	Clean-Ups	Yes. The new employees will reduce possible pollutants in the MS4. This crew will clean the right of ways throughout the city seven days a week and create a report of activities.

Monitoring data has not been required at this point to be taken or conducted to evaluate the reduction in discharge of pollutants. However, other measures have been performed that reduce and prevent pollutant discharge to the MEP. These measures include removal of pollutants through storm sewer cleaning and street sweeping. We implemented a new street sweeping rotation in October of 2015 that will record how many miles of streets that are swept and the number of inlets cleaned. In addition, the Erosion and Sediment Control Program's Site Inspection and Enforcement procedures prevent pollutants from entering the MS4. These procedures allow for the identification of inadequacies in construction site control measures and enforce maintenance operations to keep sediment on site. Therefore, these efforts are successful at preventing sediments from being washed into the MS4. Texarkana anticipates that subsequent permit terms will show further progress in the reduction of pollutants. Further, we created two new position with right of way clean up to reduce pollutants being entered into the MS4. This will be seven days a week year round. The work order system allows us to keep up with any stormwater complaints and to handle the issues in a timely manner.

4. Provide the measurable goals for each of the MCMs, and an evaluation of the success of the implementation of the measurable goals (See Example 2 in instructions):

MCM(s)	Measurable Goal(s)	Success
		Though improved from previous permit years, limited funding and resources continue to serve as the primary obstacle for implementation and expansion of BMPs and the SWMP. Construction site compliance and inspections have improved during this permit year. The City's SWMP schedule will be adjusted to allow for more flexibility in meeting the BMP measurable goals. We will continue to use the resources we have to comply with the permit.

1	Distribute Stormwater Educational Materials	<p>Met Goal – Phase II Year 2–On October 22, 2014 an Adopt-A-Spot program was implemented and a page was created on the city website promoting the Adopt-A-Spot program to the citizens of Texarkana. Attached is a copy of the webpage.</p> <p>On May 27, 2016 School Book Covers were created, printed and provided to one of the three school districts in Texarkana. Approximately 1,500 colored copies of the school book covers were delivered to Liberty Eylau School District.</p> <p>Construction brochures were updated and approximately 160 Construction Brochures were mailed out in the Spring of 2015. A database containing all relevant sectors was created in a previous permit year using GIS information to record all swimming pool owners.</p> <p>Phase II Year 2-Swimming Pool Application were updated.</p> <p>Phase II Year 3 – prepared a Power Carwash/Mobile Cleaning Business Brochure.</p> <p>Also provided “Discover Floods” book to the Parks and Recreation Dept for educating children on flooding.</p>
1	Educational Messages on Television	<p>Met Goal - Completed September 2008. Still running. Sample submitted previously. “Where Stormwater Goes Exhibit”. Message runs every 18 minutes, seven days a week.</p>
1	Stormwater Message(s) with links on City of Texarkana website.	<p>Met Goal - Stormwater webpage and links created. Links to SWMP, fact sheets, forms, MS4 permit, annual reports, NOI, etc. are on website. Link added to updated stormwater ordinance. Screenshots of website attached.</p>
1	Stormwater Message Printed on Water Bill	<p>Met Goal- Phase II Year 3 from August 2016 through December 2016, the total amount of bills sent with the Stormwater message was 43,737 bills.</p>

1	River/Stormwater System Cleanups	<p>Met Goal</p> <ul style="list-style-type: none"> • August 12, 2016 Alcoa Green Fair • May 21, 2016 City wide clean-up • October 2016 Electronics recycling • April 2016 Electronics recycling <p>Collected 50 tires and five 40 yard containers of waste;</p> <p>Please see attached graphic information as well as press release.</p> <p>Met Goal - Completed in previous reporting term. Screenshot of website hotline information was provided in the previous reporting period.</p>
1	Stormwater Hotline or Dedicated Email	<p>Met Goal - Phase II Year 3 – 35 new inlets were marked from the bridge on University Avenue to Shilling Drive.</p>
1	Designate Selected Storm Drains for Stormwater Only	<p>Completed in 2009 and still in progress. SWMP for our MS4 permit is posted on website.</p>
1	Display Stormwater Management Program on City Website for Public Review and Comment	<p>PSA plays before the movies in the park. Will be seen by the public between May 2016 and August 2016. See attached still shots.</p>
1	Public Service Announcement for public review	<p>Completed stormwater ordinances and ordinances in place for inspection and enforcement procedures.</p>
2	Implement City Ordinance and Enforcement Procedures to Prohibit and Remove Illicit Discharges	<p>Met Goal- Inspections were completed on August 12, 2016. See attached inspections.</p>
2	Visual Inspection of Selected Stormwater Outfalls During Dry Weather	<p>Due to staff constraints we did not perform inspections. We plan to do the inspection in the next reporting term.</p>
2	Development of Storm Sewer Map Showing All Outfalls and Names of Waters of the United States	<p>Met Goal - Completed in previous reporting terms. Employees received on site experience and training during municipal inspections.</p>
2	Educate City Employees, Businesses, and the General Public Regarding Hazards Associated with Illegal Discharges to Stormwater Systems	

3	Implement and Maintain Texarkana City Ordinance and Enforcement Mechanism to Require Erosion and Sediment Controls at Construction Sites > 5,000 square feet	Met Goal - Final ordinance completed in 2012 and was approved in the same year. Stormwater Permit Applications developed for all land disturbing activities.
3	Require Submittal of Construction Site SWPPP for Review by City Staff	Met Goal - Phase II Year 3 – Inspections were performed on municipal projects (Downtown Enhancement Project, Bryce’s Backage Road, Gibson Lane Extension, Phase IV University, Meadowlands Concrete Replacement and Pavilion Parkway Construction).
3	Implement Procedure for Construction Site Inspection of Runoff Controls	Met Goal - Final ordinance completed in 2012. SWP3 and Erosion and Sediment Control Plan Checklists are in use.
3	Train City Inspectors in conducting proper site inspections	Met Goal - Phase II Year 2 TXDOT Stormwater Field Inspector’s Guide notebook printed for inspectors to use for stormwater inspections on municipal projects. Continuing to use the Field Inspector’s Guide notebook in Phase II Year 3.
3	Implement Mechanism for Contractor Comment and Procedure for Comment Consideration in Regards to Construction Site Runoff Controls	Met Goal - Continuing the process of updating information on the website.
4	Create and Distribute Educational Materials for Area Developers Regarding Post-Construction Stormwater Controls	Met Goal - Completed and still in progress.
4	Implement and refine a Long-Term Operation and Maintenance Program for Post-Construction Existing Stormwater Controls	Met Goal - Completed June 2012.
5	Assess Municipal Properties for Appropriate Stormwater Pollution Prevention Controls	Partially met goal – Inspection of Fleet Services and Parks Department (Eight parks and maintenance building) have been performed. Staff will continue to inspect Municipal Properties until complete.
5	Train City employees Responsible for Municipal Operations Subject to Pollution Prevention/Good Housekeeping	Met Goal - This BMP is a continuous effort. Employees received on-site experience and training during municipal inspections.
5	Written Policy, Procedure, Schedule for Periodic Inspection and Maintenance of Stormwater System	Met Goal - Completed in 2012. “Stormwater Maintenance Program” submitted previously.

5	Provided supplies for regular cleaning of city vehicles	Met Goal – the wash bay at Fleet Services is up and running. City vehicles are being wash at this facility on a regular basis.
5	Implement Work Order System	Met Goal – The system is up and running. Daily scheduling is on-going and tasks are completed regularly.
5	Create Positions	Partially met goal- the positions are created. However, we are in the process of interviewing for these positions, which are not yet filled.

C. Stormwater Monitoring Data (Part IV Section B.2. (b))

1. The MS4 has conducted monitoring of stormwater quality and submitted in the annual report (i.e. analytical and visual observations).

Yes No

- a. Explain below or attach a summary to submit along with any monitoring data used to evaluate the success of the SWMP at reducing pollutants to the maximum extent practicable. Be sure to include a discussion of results:

Visual inspection were performed on all outfalls this term. Please see attached inspection report.

D. Impaired Waterbodies (Part IV Section B.2.(c))

1. If applicable, explain below or attach a summary of any activities taken to address the discharge to impaired waterbodies, including any sampling results and a summary of the small MS4's BMPs used to address the pollutant of concern:

No pollutant of concern has been identified by TCEQ at this time and the impairment is likely the result of historic channelization and hydromodifications. Based on the information available to the City at this time, it has been concluded that the City is not actively contributing to the impairment of Swampoodle Creek or Cowhorn Creek. The City will continue to implement the Stormwater Management Plan without specific BMPs or benchmarks targeted towards the impaired water bodies.

2. Describe the implementation of targeted controls if the small MS4 discharges to an impaired water body with an approved TMDL (*Part II Section D.4.(a)*):
3. Report the benchmark identified by the MS4 and assessment activities (*Part II Section D.4.(a)(6)*):

Benchmark Parameter <i>(Ex: Total Suspended Solids)</i>	Benchmark Value	Description of additional sampling or other assessment activities	Year(s) conducted

4. Provide an analysis of how the selected BMPs will be effective in contributing to achieving the benchmark (Part II Section D.4.(a)(4)):

Benchmark Parameter	Selected BMP	Contribution to achieving Benchmark

5. If applicable, report on focused BMPs to address impairment (Part II Section D.4.(a)(5)):

Pollutant to Address <i>(Ex: Bacteria)</i>	Description of Focused BMP	Comments/Discussion

6. Describe progress in achieving the benchmark (Part II.D.4.(a)(6)):

For example, the MS4 may use the following indicators:

- number of sources identified or eliminated;
- decrease in number of illegal dumping;
- increase in illegal dumping reporting;
- number of educational opportunities conducted;
- reductions in sanitary sewer flows (SSOs)
- increase in illegal discharge detection through dry screening

Benchmark Indicator	Description/Comments

E. Stormwater Activities (Part IV Section B.2.(d))

Describe any stormwater activities the MS4 operator has planned for the next reporting year. Use the table or attach a summary, as appropriate:

MCM(s)	BMP	Stormwater Activity	Description/Comments
1 Public Outreach	Distribute Stormwater Education Materials	Continue outreach with area schools; schoolbook covers for new school each reporting term; Work on ideas for school kids to do PSA on stormwater;	Started previous permit term and is continual process throughout reporting term. Also provided "Discover Floods" book to the Parks and Recreation Dept. for educating children on flooding.
1 Public Outreach	Educational Messages on Television	Work on new PSA to run on the Government Access Channel or similar public access channel.	Started previous permit term and is continual. Completed September 2008. Still running. Sample submitted previously. "Where Stormwater Goes Exhibit". Message runs every 18 minutes, seven days a week.
1 Public Outreach	Stormwater Message(s) with Links on City of Texarkana Website	Brainstorm new ideas about revamping website links for stormwater.	Started previous permit term and is continual. Stormwater webpage and links created. Links to SWMP, fact sheets, forms, MS4 permit, annual reports, NOI, etc. are on website. Link added to updated stormwater ordinance. Will continue to update as needed throughout reporting term.
1 Public Outreach	Stormwater Message(s) Printed on Water Bill	Determine general stormwater message to be conveyed in cooperation with utilities Department; and arrange for printing and distribute to water customers.	Started previous permit term and is continual. Phase II Year 2 from October 6, 2014 through December 15, 2014, the total amount of bills sent with the Stormwater message was 31,049 bills. Phase II Year 3 from August 2016 to the present the total amount of bills sent with the Stormwater message was 43,737 bills.
1 Public Outreach	River/Stormwater System Cleanups	Organize and/or participate with volunteer efforts to clean up debris and trash in the creeks or that could end up in local creeks and streams including stormwater outfalls; emphasize cleanup of floatables.	Started previous permit term and is continual. Biannual recycling and city wide community clean-ups. Earth Day event, if any. Staff was invited to partner with TWU on any future outreach they perform.
1 Public Outreach	Stormwater Hotline or Dedicated Email	Continual Process.	Completed in previous reporting term. See attached screenshot of website hotline information.

1 Public Outreach	Designate Selected Storm Drains for Stormwater Only	Identify storm drains that will have message affixed; and Organize public works employees and/or volunteers and provide with marking materials; have volunteers affix message to drains.	Phase II Year 3 – 35 new inlets were marked from the bridge on University Avenue to Shilling Drive. Will continue with next section of storm drains in next reporting term.
1 Public Outreach	Display Stormwater Management Program on City Website for Public Review and Comment	Continual Process.	Created email or similar outlet for gathering public comments; and develop method for reviewing and implementing public comments.
2 Illicit Discharge Detection and Elimination	Implement City Ordinance and Enforcement Procedures to Prohibit and Remove Illicit Discharges	Continue to implement and update as necessary the City Ordinance prohibiting non-stormwater discharges to the MS4, Including exception for allowable non-stormwater discharges.	Started previous permit term and is continual. Completed stormwater ordinances and ordinances in place for inspection and enforcement procedures.
2 Illicit Discharge Detection and Elimination	Visual Inspection of Selected Stormwater Outfalls During Dry Weather	<p>Revise and update as necessary the existing procedures and criteria for inspecting and ranking outfalls.</p> <p>Continue to develop and revise inspection procedures, including illicit discharge reporting procedures, for City staff to perform stormwater outfall dry weather inspections.</p> <p>Develop procedures to prevent and correct leaking on-site sewage disposal systems.</p> <p>Continue to develop procedure for reporting any discovered illicit discharge to enforcement body for removal.</p>	<p>Revisions and update are an annual process.</p> <p>Inspections were completed this reporting term and inspection report is attached. Staff will continue to monitor and inspect Outfalls.</p>

<p>2 Illicit Discharge Detection and Elimination</p>	<p>Development of Storm Sewer Map Showing All Outfalls and Names of Waters of The US</p>	<p>Compile stormwater map data from necessary sources. Review data to locate outfalls and conduct field verification of all outfall locations. Create electronic versions of outfall map.</p>	<p>90% has been completed in electronic format and paper maps are no longer being developed. Limited availability of staff prevents this activity to be completed on schedule. Data is being downloaded from the GPS into our mapping system and integrated with all map layers for the city. Electronic format sample attached – “Stormwater Features and Outfalls” . Data is being downloaded from the GPS into our mapping system and integrated with all map layers for the city.</p>
<p>2 Illicit Discharge Detection and Elimination</p>	<p>Educate City Employees, Businesses, and the General Public Regarding Hazards Associated with Illegal Discharges to Stormwater Systems</p>	<p>Develop and/or procure educational materials discussing the stormwater hazards of illicit discharges; and Distribute to City employees, businesses and general public</p>	<p>Completed in previous reporting terms. Employees received on site experience and training during municipal inspections</p>
<p>3 Construction Site Runoff Controls</p>	<p>Implement and Maintain Texarkana City ordinance and enforcement mechanism to Require Erosion and Sediment controls at Construction Sites >5,000 square feet</p>	<p>Continue to implement and revise as necessary the City ordinance requiring waste, erosion, and sediment controls at construction sites > 5,000 square feet, and at sites that are part of a larger common plan of development.</p>	<p>Final ordinance completed in 2012 and was approved in the same year. Stormwater Permit Applications developed for all land disturbing activities. Started previous permit term and is continual.</p>
<p>3 Construction Site Runoff Controls</p>	<p>Require Submittal of Construction Site SWPPP for review by City Staff</p>	<p>Implement policy and ordinance that requires contractors to submit TCEQ approved Construction SWPPP. Review of all submitted construction SWPPP's for compliance with City ordinance.</p>	<p>Final ordinance completed in 2012. SWP3 and Erosion and Sediment Control Plan Checklists are in use. Phase II Year 3 – Inspections were performed on municipal projects (Downtown Enhancement Project, Bryce's Backage Road, Gibson Lane Extension, Phase IV University, Meadowlands Concrete Replacement and Pavilion Parkway Construction). Started previous permit term and is continual.</p>

<p>3 Construction Site Runoff Controls</p>	<p>Implement Procedures for Construction Site Inspection of Runoff Controls</p>	<p>Develop inspection procedures</p>	<p>Phase II Year 3 – Inspections were performed on municipal projects (Downtown Enhancement Project, Bryce's Backage Road, Gibson Lane Extension, Phase IV University, Meadowslands Concrete Replacement, Kidtopia Skate Park and Pavilion Parkway Construction). Started previous permit term and is continual.</p>
<p>3 Construction Site Runoff Controls</p>	<p>Train City Inspectors in Conducting Proper Site Inspections</p>	<p>Develop training material for construction site inspections. Perform City inspectors training on proper waste, erosion, and sediment controls at construction sites. Have City inspectors implement inspection procedures during construction site inspections.</p>	<p>Phase II Year 2 TXDOT Stormwater Field Inspector's Guide notebook printed for inspectors to use for stormwater inspections on municipal projects. Started previous permit term and is continual.</p>
<p>3 Construction Site Runoff Controls</p>	<p>Implement Mechanism for contractor comment and procedures for comment consideration in regards to construction site runoff controls</p>	<p>Continue to operate construction stormwater controls hotline and website email for receiving comments from construction contractors and citizens. Solicit and receive verbal and/or written input from contractors and citizens through a stormwater hotline, public meetings, and surveys. A Location on the City's website will also be available for contractors and/or citizens to email concerns or potential violations to City staff. Track comments, complaints, and investigations received from contractors and/or public.</p>	<p>Started previous permit term and is continual. We have implemented a work order system that allows citizens to request work to be performed or initiate a complaint. The system will respond to the citizens via email if they request or log a complaint on the website or call the hotline and leave a message. This system provides a history for each complaint which is archived as a job or complaint has been investigated and/or completed. The system is in use and will be continual.</p>

<p>4 Post Construction Stormwater Management in New Development and Redevelopment</p>	<p>Create and Distribute Educational Materials for Area Developers regarding Post-Construction Controls</p>	<p>Create written educational material regarding Texarkana construction stormwater control requirements and Deliver educational materials to area developers and contractors as part of the building permits process</p>	<p>Completed and still in progress.</p>
<p>4 Post Construction Stormwater Management in New Development and Redevelopment</p>	<p>Implement and refine a Long-Term Operation and Maintenance Program for Post-Construction Existing Storm Water Controls</p>	<p>Conduct inventory of structural runoff controls; Develop schedules for regular inspection and maintenance for each structural control; and Notify owner of stormwater control(s) in their possession with prescribed inspection and maintenance; and inspect control(s) to ensure maintenance is being addressed.</p>	<p>Completed June 2012. Started previous permit term and is continual.</p>
<p>5 Pollution Prevention/Good Housekeeping for Municipal Operations</p>	<p>Assess Municipal Properties for Appropriate Stormwater Pollution Prevention Controls</p>	<p>Periodically inspect City properties to determine what stormwater controls are in place and determine what additional controls are warranted; Identify any illicit discharges, and determine if existing structural controls are properly maintained; and generate written report with recommendations and install and implement additional stormwater pollution prevention controls at City owned properties.</p>	<p>Completed in 2012. Checklists, findings, and memos previously attached. Partial inspections completed during this reporting term. Inspection of Fleet Services was performed as well as the Inspections of the Parks and Recreation facilities. The inspections of the remaining City Facilities will be scheduled in the next reporting term.</p>
<p>5 Pollution Prevention/Good Housekeeping for Municipal Operations</p>	<p>City Employees using City vehicles/Good Housekeeping</p>	<p>Prepared the wash bay at fleet services for the all city employees with city vehicles. Supplied all supplies including lockers to store their equipment for cleaning city vehicles.</p>	<p>Complete and is continual on a regular basis.</p>
<p>5 Pollution Prevention/Good Housekeeping for Municipal Operations</p>	<p>Train City Employees Responsible for Municipal Operations Subject to Pollution Prevention/Good Housekeeping</p>	<p>Develop and/or procure training materials; and conduct training directed at preventing and reducing stormwater pollution from municipal operations.</p>	<p>This BMP is a continuous effort. Employees received on-site experience and training during municipal inspections.</p>

<p>5 Pollution Prevention/Good Housekeeping for Municipal Operations</p>	<p>Written Policy, Procedures and Schedule for periodic inspection and Maintenance of Stormwater System</p>	<p>Research existing stormwater system regarding potential cleaning and maintenance requirements; and Implement and revise as necessary the policy, procedures, and schedule for system maintenance including proper disposal of waste removed from MS4.</p>	<p>Completed in 2012. "Stormwater Maintenance Program" submitted previously.</p>
--	---	--	--

F. Modifications (Part IV Section B.2.(e))

1. Changes have been made or are proposed to the SWMP since the NOI or the last annual report, including changes in response to TCEQ's review.
 ___ Yes X No

If 'Yes', report on changes made to measurable goals and BMPs:

MCM(s)	Measurable Goal(s) or BMP(s)	Implemented or Proposed Changes (Submit NOC as needed)

Note: If changes include additions or substitutions of BMPs, include a written analysis explaining why the original BMP is ineffective or not feasible and why the replacement BMP is expected to achieve the goals of the original BMP.

2. Explain additional changes or proposed changes not previously mentioned (i.e. dates, contacts, procedures, annexation of land etc.):

G. Additional BMPs (Part IV Section B.2.(f))

Provide a description and schedule for implementation of additional BMPs that may be necessary, based on monitoring results, to ensure compliance with applicable TMDLs and implementation plans.

BMP	Description	Implementation Schedule (Start Date etc.)	Status/Completion Date (completed, in progress, not started)

H. Additional Information (Part IV Section B.2.(g))

1. Is the permittee relying on another entity/ies to satisfy some of its permit obligations?

Yes No

If 'Yes,' provide the name(s) of other entity/ies and an explanation of their responsibilities (add more spaces or pages if needed):

Name and Explanation:

2.a. Is the named permittee sharing a SWMP with other entities?

Yes No

2.b. If 'yes,' is this a system-wide annual report including information for all permittees?

Yes No

If 'Yes,' list all associated permit numbers and permittee names (add additional spaces or pages if needed):

Authorization Number: _____

Permittee: _____

I. Construction Activities (Part IV Section B.2.(h-i))

1. The number of construction projects in the jurisdiction of the MS4 where the permittee was not the construction site operator (as provided in submittals to the MS4 operator via notices of intent or site notices) 37 down from 46 last year.

2.a. Does the permittee utilize the optional seventh MCM related to construction?

Yes No

2. b. If 'yes,' then provide the following information for this permit year:

Although the City does not utilize the seventh MCM, numerous municipal construction projects have occurred in adherence to State, Federal, and City regulations. Some of these projects were road construction projects and others were projects to address stormwater/drainage issues. A list of all projects is attached as Exhibit "B".

The number of municipal construction activities authorized under this general permit	No municipal construction activities were started during this permit term. However, there were some started in the previous permit term which ran through to this permit term. Those are Phase 4 and Morris projects.
The total number of acres disturbed for municipal construction projects	Phase 4 – acreage disturbed was 9.7 acres. Morris – acreage disturbed was 9.8 acres. Downtown Sidewalk Project

Note: Though the seventh MCM is optional, implementation must be requested on the NOI or on a NOC and approved by the TCEQ.

J. Certification

I certify under penalty of law that this document and all attachments were prepared under my direction or supervision in accordance with a system designed to assure that qualified personnel properly gathered and evaluated the information submitted. Based on my inquiry of the person or persons who manage the system, or those persons directly responsible for gathering the information, the information submitted is, to the best of my knowledge and belief, true, accurate, and complete. I am aware that there are significant penalties for submitting false information, including the possibility of fine and imprisonment for knowing violations.

Name (printed): JOHN A WHITSON Title: CITY MANAGER

Signature:  Date: 19 DEC 16

Name (printed): _____ Title: _____

Signature: _____ Date: _____

Name (printed): _____ Title: _____

Signature: _____ Date: _____

Name (printed): _____ Title: _____

Signature: _____ Date: _____

Name (printed): _____ Title: _____

Signature: _____ Date: _____

Note: If this is this a system-wide annual report including information for all permittees, each permittee shall sign and certify the annual report in accordance with 30 TAC §305.128 (relating to Signatories to Reports).



Help Protect Your Water

Storm Water / Storm Drains

During large storms, stormwater runoff can flow quickly over the ground and cause flash flooding. To prevent serious flooding, storm drains channel water into natural washes and off the streets.

The Storm Drain System is responsible for carrying all stormwater from Texarkana to surrounding creeks which run to the area lakes and rivers. The Storm Drain System is not connected to the Wastewater System, which drains water from your home. Storm drains do not send water to a treatment facility where it is cleaned. That means the water, and everything it touches from dirt, motor oil, trash and pet waste flows straight into your local bodies of water!

Help us protect water sources by cleaning up debris from the streets! Pick up pet waste and dispose. Mulch grass clippings. Use commercial carwashes. Don't over fertilize your lawn.

REMEMBER:

STORMWATER IS NEVER TREATED.
WHATEVER GOES DOWN THE STORM DRAIN
GOES DIRECTLY INTO YOUR DRINKING WATER,
FISHING WATER AND SWIMMING WATER!

WORD SCRAMBLE

Put the letters in the right order to complete the sentence!

All living things need _____ to live.
T A W E R

When water evaporates, it travels into the air and becomes part of a

D L O C U

Less than 1% of all the water on the earth is _____ water.
H R F E S

Use a _____ blade when mowing your lawn and leave _____
L H C G I M U N S G S R A
clippings to naturally fertilize your lawn.

Do not dump pesticides or _____ into a storm drain.
S I M E C C L A H

HOW CAN YOU HELP?

Don't sweep or blow yard waste into the street or sidewalk.

Don't dump yard waste into the inlets, storm drains or on creek banks.

Don't leave yard waste on the pavement or in areas where it will be washed into the storm drain system.

Don't pour leftover pesticides on the pavement, inlet or storm drain.

What Can You Do to Minimize Yard Waste From Polluting Our Water Ways?

Clean up yard waste that gets to the streets, sidewalks and driveways.

Use a mulching mower, or a mulching blade, and leave grass clippings on the lawn as fertilizer.

Use fallen leaves as winter or summer mulch, or shred them and leave them on the lawn.

Clean up and reuse granular lawn care products, such as fertilizers, that fall on the streets, sidewalks and driveways.

Use fertilizers and pesticides as directed on the product label and dispose of empty containers properly.



Report illegal dumping!
CITY OF TEXARKANA, TEXAS
STORMWATER MANAGEMENT

919 Elm Street
Texarkana, Texas 75501
Office: 903-798-3948
www.ci.texarkana.tx.us
Email: laura.puckett@txkusa.org



TEX-Puckett, Laura

From: TWU-Cowdery, Tammy
Sent: Wednesday, November 16, 2016 9:45 AM
To: TEX-Puckett, Laura; TWU-White, Pamela; TWU-Shaw, Melissa; TWU-White, Cece; TWU-McDonald, Cindy
Cc: TEX-Henslee, Dustin
Subject: RE: Stormwater Reporting.

Good morning Laura

We have sent the message on approximately 43,737 bills and are still currently running the message. This means that the message has been on the bills since mid-August.

Regards

Tammy Cowdery

Billing Technician
Texarkana Water Utilities
Ph: (903) 798-3832
Fax: (903) 791-0724
cowdery@txkusa.org

If you don't like something, change it. If you can't change it, change your attitude. – Maya Angelou

 Help save our environment - do you need to print this email?

From: TEX-Puckett, Laura
Sent: Wednesday, November 16, 2016 9:35 AM
To: TWU-Cowdery, Tammy <Cowdery@txkusa.org>; TWU-White, Pamela <pwhite@txkusa.org>; TWU-Shaw, Melissa <mshaw@txkusa.org>; TWU-White, Cece <white@txkusa.org>; TWU-McDonald, Cindy <mcdonald@txkusa.org>
Cc: TEX-Henslee, Dustin <dustin.henslee@txkusa.org>
Subject: FW: Stormwater Reporting.

Hello Ladies: Can you tell me how many bills went out with the "Stormwater" Lawn Chemicals message on it and what months it ran?

Thanks.



Laura Puckett
Administrative Coordinator

Stormwater Management
Dept. Engineering & Infrastructure
City of Texarkana, Texas
Office: (903) 798-3948
Fax: (903) 792-6419
Email: laura.puckett@txkusa.org

Email communications through this office may be subject to Texas Public Records laws and may be shared with others.

From: TEX-Puckett, Laura
Sent: Wednesday, August 10, 2016 11:37 AM
To: TWU-White, Pamela <pwhite@txkusa.org>; TWU-Cowdery, Tammy <Cowdery@txkusa.org>; TWU-Shaw, Melissa <mshaw@txkusa.org>; TWU-White, Cece <White@txkusa.org>; TWU-McDonald, Cindy <mcdonald@txkusa.org>
Subject: Stormwater Reporting.

It is that time of the year again for my State Report. I would like to do another water bill message. If you don't mind! Please let me know if you all have any issues with this message.
The wording for the message this year is below and I will also attach a pdf format as well:

Lawn Chemicals

Fertilizers and pesticides are among the many common stormwater pollutants that can degrade water quality. Use fertilizers, herbicides and pesticides sparingly and follow label instructions. Keep fertilizer off streets and sidewalks, and away from water bodies and stormwater drains.
Avoid applying within 10 feet of paved areas, storm drains, or water bodies. Broadcast spreaders must have a deflector shield to keep granular fertilizer off paved surfaces and out of storm drains and waterways. Only apply fertilizers during dry weather and use zero phosphorous lawn fertilizers. If any dry chemicals or fertilizer should fall onto paved areas, immediately sweep or blow back onto the lawn or properly contain for reuse.

REPORT ANY ILLEGAL DUMPING INTO A STORMWATER DRAIN. Refer to the City's Stormwater Ordinance for rules that apply (Chapter 125) at <https://library.municode.com/index.aspx?clientid=10286>. If you have any questions you may contact the City of Texarkana, Texas, Public Works Stormwater Management, Dusty Henslee or Laura Puckett at (903)798-3948.



Laura Puckett
Administrative Coordinator
Stormwater Management
Dept. Engineering & Infrastructure
City of Texarkana, Texas
Office: (903) 798-3948

Fax: (903) 792-6419

Email: laura.puckett@txkusa.org

Email communications through this office may be subject to Texas Public Records laws and may be shared with others.

TEX-Puckett, Laura

From: TWU-White, Pamela
Sent: Thursday, August 11, 2016 2:41 PM
To: TEX-Puckett, Laura; TWU-Cowdery, Tammy; TWU-Shaw, Melissa; TWU-White, Cece; TWU-McDonald, Cindy
Subject: RE: Stormwater Reporting.

Laura

Tammy confirmed that the Lawn Chemicals message will be on the bills for the Texas residential and commercial customers; one cycle will go out tomorrow. Do you want this run for one month? If no one else has a message for next month, the Lawn Chemicals can remain on the bill message. Pam

From: TEX-Puckett, Laura
Sent: Wednesday, August 10, 2016 11:37 AM
To: TWU-White, Pamela <pwhite@txkusa.org>; TWU-Cowdery, Tammy <Cowdery@txkusa.org>; TWU-Shaw, Melissa <mshaw@txkusa.org>; TWU-White, Cece <white@txkusa.org>; TWU-McDonald, Cindy <mcdonald@txkusa.org>
Subject: Stormwater Reporting.

It is that time of the year again for my State Report. I would like to do another water bill message. If you don't mind! Please let me know if you all have any issues with this message.

The wording for the message this year is below and I will also attach a pdf format as well:

Lawn Chemicals

Fertilizers and pesticides are among the many common stormwater pollutants that can degrade water quality.

Use fertilizers, herbicides and pesticides sparingly and follow label instructions. Keep fertilizer off streets and sidewalks, and away from water bodies and stormwater drains.

Avoid applying within 10 feet of paved areas, storm drains, or water bodies. Broadcast spreaders must have a deflector shield to keep granular fertilizer off paved surfaces and out of storm drains

and waterways. Only apply fertilizers during dry weather and use zero phosphorous lawn fertilizers. If any dry chemicals or fertilizer should fall onto paved areas, immediately sweep or blow back onto the lawn or properly contain for reuse.

REPORT ANY ILLEGAL DUMPING INTO A STORMWATER DRAIN. Refer to the City's Stormwater Ordinance for rules that apply

(Chapter 125) at <https://library.municode.com/index.aspx?clientid=10286>. If you have any questions you may contact the City of Texarkana, Texas,

Public Works Stormwater Management, Dusty Henslee or Laura Puckett at (903)798-3948.



Laura Puckett
Administrative Coordinator
Stormwater Management
Dept. Engineering & Infrastructure

City of Texarkana, Texas

Office: (903) 798-3948

Fax: (903) 792-6419

Email: laura.puckett@txkusa.org

Email communications through this office may be subject to Texas Public Records laws and may be shared with others.

Water bill message

Lawn Chemicals

Fertilizers and pesticides are among the many common stormwater pollutants that can degrade water quality.

Use fertilizers, herbicides and pesticides sparingly and follow label instructions. Keep fertilizer off streets and sidewalks, and away from water bodies and stormwater drains. Avoid applying within 10 feet of paved areas, storm drains, or water bodies. Broadcast spreaders must have a deflector shield to keep granular fertilizer off paved surfaces and out of storm drains and waterways. Only apply fertilizers during dry weather and use zero phosphorous lawn fertilizers. If any dry chemicals or fertilizer should fall onto paved areas, immediately sweep or blow back onto the lawn or properly contain for reuse.

REPORT ANY ILLEGAL DUMPING INTO A STORMWATER DRAIN. Refer to the City's Stormwater Ordinance for rules that apply (Chapter 125) at <https://library.municode.com/index.aspx?clientid=10286>. If you have any questions you may contact the City of Texarkana, Texas, Public Works Stormwater Management, Dusty Henslee or Laura Puckett at (903)798-3948.

May 21, 2016



A cross community effort to keep
both sides of Texarkana
CLEAN - NEAT - GREEN - PRETTY

City Wide Clean Up

SATURDAY MAY 21st 2016

Texarkana Texas and Texarkana, AR

#MAY21TXK

SPONSORED BY:

WASTE MANAGEMENT

KEEP TEXARKANA
BEAUTIFUL

CITY BEAUTIFUL

LEADERSHIP
TEXARKANA

CITY OF TEXARKANA,
TEXAS

CITY OF TEXARKANA,
ARKANSAS

SHOW YOU ARE IN MAY 21st 2016

*Clean up your yard. Help a needy neighbor with theirs.

*Pick up trash in a needed area, recycling items when possible.

*Dispose of unwanted items for free at one of 5 dumpster locations around Texarkana:

1. Collins Senior Center 3000 Texas Boulevard Texarkana, TX
2. Bringle Lake, West Park 7602 Bringle Lake Rd Texarkana, TX
3. Pecan Ridge 2210 W. 15th Street Texarkana, TX
4. To be announced Texarkana, AR
5. To be announced Texarkana, AR

*Do your own thing to make our community clean, neat green and pretty

AND... Show Everyone what YOU did and how much fun YOU made it on Twitter and Facebook at #MAY21TXK



Dear Pam,

Alcoa Mill Products is hosting a Green Fair on Friday August 12th and we would like Texarkana Water Utilities to host a table and share your great work!

The Green Fair will be a fun one day event that features informative demonstrations, giveaways, games, tips, resources, and community connections to promote saving energy and money.

We would be delighted if you would join us!

EVENT DETAILS:
AUGUST 12, 2016
3 PM – 8 PM
ALCOA MILL PRODUCTS
300 ALUMAX DRIVE, TEXARKANA, TX 75501

[Kindly RSVP to Ellie Ramm, ramme@c2es.org by June 24](mailto:ramme@c2es.org)

Event Day Logistics

The event will be held indoors. You will have access to a table, chairs and light refreshments. Security clearance will be required. Once you confirm your attendance, we will share additional details regarding the event. We will also host an optional call and answer any questions you may have.

About the Green Fair

The purpose of the Green Fair is to help employees learn about products and lifestyle choices that are good for the environment and their pocketbook. The event is part of Alcoa's commitment to sustainability and is a collaboration between the Make an Impact team at the Center for Climate and Energy Solutions (C2ES) and the Alcoa Foundation.

Storm Drain Inlet Markings Plan for 2nd Permit and Beyond

Year 6 - University Ave. (Richmond Rd. to TAMUT Campus Drive)

Mark remaining inlets that haven't been marked (approx. 20)

Year 7 - University Ave. (TAMUT to Bridge)

Mark all inlets (approx. 37)

Year 8 - University Ave. (Bridge to Shilling)

Mark all inlets (approx. 35)

Year 9 - TAMUT Road (Divided Blvd. into TAMUT Main Campus)

Mark all inlets (approx. 41)

Year 10 - University Ave. (McKnight to I-30)

Mark all remaining inlets (approx. 27)

Year 11 - Gibson Lane (University to Richmond)

Mark all remaining (approx. 30)

Year 12 Pavillion Parkway, University Park, Gibson Lane (King's Highway), West Park Blvd.

Mark all inlets (approx. 40)

Year 13 Galleria Oaks and road tie ins, Morris Lane, Arista, Stoneledge, Cowhorn Creek, Sam Warren, N. Cowhorn Creek Loop

Mark remaining inlets on Arista, Stoneledge, and Morris (approx. 8)

Mark remaining on Galleria Oaks (Cowhorn to Summerhill – approx. 11)

Mark all inlets on Cowhorn Creek (Moores to I-30 - approx. 11)

Mark all inlets on Sam Warren (approx. 2)

Mark all inlets on N. Cowhorn Creek Loop (approx. 4)

Year 14 Galleria Oaks, Ozark Drive, Moores Lane, Summerfield Dr., Fieldcrest Dr., Serenity

Mark all inlets on Galleria Oaks (east of Summerhill – approx. 3)

Mark all inlets on Ozark Dr (approx. 5)

Mark all inlets on Moores Lane (east of Summerhill – approx. 1)

Mark all inlets Summerfield (approx. 4)

Mark all inlets on Fieldcrest (approx. 2)

Mark all inlets on Serenity (from Summerhill to curve – approx. 3)

Year 15 – Walton Drive, University

Mark all inlets on Walton Drive (approx. 39)

Mark all inlets on University (south of I-30 – approx. 2)

Year 16 – Old Boston Road, Belt Road, Cowhorn Creek, S. Cowhorn Creek Loop

Mark all inlets on Belt Road (approx. 5)

Mark all inlets on Old Boston Road (approx. 4)

Mark all inlets on Cowhorn Creek (south of I-30 – approx. 17)

Mark all inlets S. Cowhorn Creek Loop (approx. 1)

Year 17 – Kennedy Lane, College

Mark all inlets on Kennedy (approx. 16)

Mark all inlets on College (Belt to Texas – approx. 19)

Year 18 – Westlawn, Waco, Kilgore, Gazola, Terry

Mark all inlets on Westlawn (approx. 15)

Mark remaining inlets on Waco (approx. 4)

Mark remaining inlets on Kilgore (approx. 2)

Mark all inlets on Gazola (approx. 2)

Mark all inlets on Terry (approx. 3)

Year 19 – Area 1

Mark remaining inlets in Area 1

Year 20 – Area 2

Mark remaining inlets in Area 2

Year 21 – Area 3

Mark remaining inlets in Area 3

Year 22 – Area 4

Mark remaining inlets in Area 4

Year 23 – Area 5

Mark remaining inlets in Area 5

Year 24 – Area 6

Mark remaining inlets in Area 6

Year 25 – Area 7

Mark remaining inlets in Area 7

Year 26 – Area 8

Mark remaining inlets in Area 8

*This plan may be revised based on development of areas and new inlet locations. This plan shall be updated yearly.

TEX-Puckett, Laura

From: TEX-Eitel, Jeff
Sent: Wednesday, October 12, 2016 8:09 AM
To: TEX-Puckett, Laura
Cc: TEX-Henslee, Dustin; TEX-Smith, Danny
Subject: RE: Stormdrain Markings

Laura,
Scott Baird marked the inlets last week
The work order that he created is #16-02866.
He is going to get a couple of pictures and attach them to the work order before we archive it.

Thanks,
Jeff

From: TEX-Puckett, Laura
Sent: Tuesday, October 11, 2016 9:00 AM
To: TEX-Eitel, Jeff <Eitel@txkusa.org>; TEX-Smith, Danny <dsmith@txkusa.org>
Cc: TEX-Henslee, Dustin <dustin.henslee@txkusa.org>
Subject: Stormdrain Markings

When you all complete the storm drain markings, can you have someone email me confirmation in writing that they have completed the storm drain markings?
I will need this information for my reporting. Thanks in advance for your assistance.



Laura Puckett
Administrative Coordinator
Stormwater Management
Dept. Engineering & Infrastructure
City of Texarkana, Texas
Office: (903) 798-3948
Fax: (903) 792-6419
Email: laura.puckett@txkusa.org

Email communications through this office may be subject to Texas Public Records laws and may be shared with others.

Stormwater Dry Weather Outfall Inspection Notes

Date	Body of Water	Inspection Performed By	Notes
8/12/2016	Days Creek	Laura Puckett & Danny Smith	Days Creek was inspected at the extreme South end from the bridge on the Loop 151. The reason for this is because the gate was locked and could not be accessed. However, the creek appeared to be clear and running. There were no visible discoloration, or vegetation at inspection site. Also, there was no odor present.
8/12/2016	Wagner Creek	Laura Puckett & Danny Smith	Wagner Creek was inspected from South Lake Drive. The creek was clear and running. There was no discoloration and no odor detected. However, at the inspection site there is a large sewer line that has limbs and debris beginning to dam up that area and could in the future restrict a steady flow of water. At present time water is flowing.
8/12/2016	Howard Creek	Laura Puckett & Danny Smith	Howard Creek is clear and running. No vegetation or discoloration noted. Also there is no odor present.
8/12/2016	McKinney Bayou	Laura Puckett & Danny Smith	McKinney Bayou could not be accessed. The area of inspection is extremely overgrown with cattails. The area is wet and water is present although I could not actually see it because of the growth. There is no odor present.
8/12/2016	North Stateline Ditch	Laura Puckett & Danny Smith	North Stateline Ditch could not be accessed because it is overgrown with vegetation and cattails. Access to this outfall is on TXDOT right of way and stays wet much of the year.

McKinney Bayou Outfall



Wagner Creek Outfall



Howard Creek Outfall



W. North Stateline Ditch Outfall



Days Creek Outfall





Memo

To: Jeff Heminger, Fleet Superintendent
From: Laura Puckett, CSI, Administrative Coordinator
cc: Dustin Henslee, P.E.,CFM, CSI, City Engineer
Date: August 24, 2016
Re: Stormwater Inspection

Today, I completed the stormwater inspection for Fleet Services. I appreciate Angela Humphrey taking the time to help out! I am attaching the official report that I will be including as an attachment to my yearly reporting to TCEQ.

Incidentally, we need a copy of the Stormwater Permit Renewal for your current permit and on each occasion in the future as you renew the permit.

Overall, I am pleased with Fleet Services. However, we can all approve upon stormwater controls. Therefore, please make sure that all flammable liquids/fuels are stored in the proper fire proof room/area.

Also, the wash bay has had an accumulation of dirt/debris on the drain/grate. Angela informed me that each employee using the bay should clean up after their use. Therefore, I will send out a memo to each department asking them to inform their employees that they are responsible for cleaning up the mess their vehicles leave in the wash bay.

If you have questions or concerns, please do not hesitate to contact me.

Thanks.

The City of Texarkana, Texas
Stormwater Management
919 Elm Street
Phone: 903-798-3948
Fax: 903-792-6419
dustin.henslee@txkusa.org
laura.puckett@txkusa.org

Stormwater: General Inspection

City Owned Facilities



General inspections to determine if additional best management practices (BMPs) may be required.

Narrative of type facility: This facility does all maintenance for city vehicles and equipment. City vehicles are maintained on a schedule all year long. City vehicles are fueled at this location and oil and fluids are changed and flushed regularly.

Division: Public Works **Bldg#/ Area:** Elm **Date:** 8/24/2016
Location: Fleet Maintenance Bldg **Time:** 8:00 a.m.
Inspector: Laura Puckett **Title:** CSF, Admin Coordinator

GOOD HOUSEKEEPING

(Circle one)

1.	Are outside areas kept neat, clean, and orderly?	<u>yes</u>	no	n/a
2.	Are storm drain inlets labeled "No Dumping, Drains to Waterways?"	<u>yes</u>	no	<u>n/a</u>
3.	Are garbage cans, waste bins, and dumpsters covered?	<u>yes</u>	no	n/a
4.	Has the stormwater flow been recently altered?	yes	no	<u>n/a</u>
	If yes, does the alteration maintain SWPPP compliance?	yes	no	<u>n/a</u>
5.	Are stormwater drainage paths clear? Grates clean?	yes	no	<u>n/a</u>
6.	Are vehicles or equipment cleaned at this facility?	<u>yes</u>	no	n/a

All city vehicles should be wash at the wash bay located at Fleet Services

HAZMAT STORAGE

8.	Are vehicles fueled at this location?	<u>yes</u>	no	n/a
	If yes, are fuel tanks locked and/or properly operated?	<u>yes</u>	no	n/a
	If yes, are measures taken to protect storm drains from spills?	<u>yes</u>	no	n/a

Briefly describe prevention methods: Auto shutoff controls and spill response materials supplied and used to contain any spills

9.	Do aboveground tanks (liquid) have secondary containment?	<u>yes</u>	no	n/a
10.	Are containment structures or surface slabs liquid tight?	<u>yes</u>	no	n/a
11.	Does this site store hazardous materials such as solvents, pesticides, or acids?	yes	<u>no</u>	n/a
	If yes, are containers weathertight or covered?	yes	no	<u>n/a</u>
	If yes, are ignitable or reactive wastes stored at least 50 feet from the property line?	yes	no	<u>n/a</u>
12.	Has the facility had a hazardous waste spill since the last inspection?	yes	<u>no</u>	n/a

If yes, was the problem resulting in the spill corrected explain: _____

OTHER BEST MANAGEMENT PRACTICES

13.	Does this site store hazardous or other materials that could impact the storm drain such as detergent, paint, or powders?	<u>yes</u>	no	n/a
	If yes, are they stored in a manner prohibiting exposure to rain or runoff?	<u>yes</u>	no	n/a
14.	Are waste materials kept on site in closed leaktight containers?	<u>yes</u>	no	n/a
15.	Are all leaking vehicles or equipment equipped with drip pans?	<u>yes</u>	no	n/a
16.	Are erodible soils uncovered or exposed to rainwater?	yes	no	<u>n/a</u>
17.	Is the ground surface stained by oil or significant materials?	yes	<u>no</u>	n/a
	If yes, has the source been found and contained?	yes	no	<u>n/a</u>
18.	Are truck unloading areas covered?	yes	no	<u>n/a</u>
19.	Does the facility have wastes, products, salvaged materials and recyclables stored properly?	<u>yes</u>	no	n/a
20.	Does the facility have a clarifier/oil/water separator?	<u>yes</u>	no	n/a
	If yes, is it clean and functioning properly?	<u>yes</u>	no	n/a
21.	Has this facility received a complaint regarding stormwater discharge?	yes	<u>no</u>	n/a
	If yes, has the problem been addressed?	yes	no	n/a
22.	Have personnel received training on Stormwater Pollution Prevention?	<u>yes</u>	no	n/a
23.	Are spill response materials available? (Check all that apply)	<u>yes</u>	no	n/a

Sand Rice Hulls _____ Sorbent Booms/Pillows/Blankets _____

Kitty Litter _____ Neutralizer _____ Drip Pans

Oil dry & oil dry pads

24. Identify existing management practices employed to reduce pollutants in stormwater discharges: (Check all that apply and describe conditions)

- | | |
|---|---|
| Good Housekeeping <input checked="" type="checkbox"/> | Sorbent Booms _____ |
| Containment <input checked="" type="checkbox"/> | Spill Mitigation <input checked="" type="checkbox"/> |
| Berms _____ | Oil/Water Separator <input checked="" type="checkbox"/> |
| Sand Filter/Recycling _____ | Dead-end Sumps _____ |
| Retention Facilities _____ | Other _____ |
| Silt Fence _____ | |

25. Action Items:

- a. Place flammables in proper storage
- b. _____
- c. _____



Memo

To: Robby Robertson, Parks Director & Kenny Jordan Parks Foreman
From: Laura Puckett, CSI, Administrative Coordinator
cc: Dustin Henslee, P.E.,CFM, CSI, City Engineer
Date: September 29, 2016
Re: Stormwater Inspection

On September 21, 2016, I completed the stormwater inspection for Parks & Recreation. I am attaching the official report that I will be including as an attachment to my yearly reporting to TCEQ.

Overall, I am pleased with Parks & Recreation. However, we can all approve upon stormwater controls. Therefore, please make sure that you place lids on all trash containers.

Please review my report for each park and especially the "Action Item" notes.

If you have questions or concerns, please do not hesitate to contact me.

Thanks.

The City of Texarkana, Texas
Stormwater Management
919 Elm Street
Phone: 903-798-3948
Fax: 903-792-6419
dustin.henslee@txkusa.org
laura.puckett@txkusa.org



Stormwater: General Inspection City Owned Facilities

General inspections to determine if additional best management practices (BMPs) may be required.

Division: Parks – Bell Park **Bldg#/ Area:** _____ **Date:** 09/21/2016
Location: 3208 Lincoln Street, Texarkana, Texas **Time:** 12:43
Inspector: Laura Puckett **Title:** CSI – Administrative Coordinator

Narrative of type facility: This park consist of playground equipment, basketball courts, and pavilion. Most surface drainage runs to a swale in middle of property. Grass is established throughout this park. There is one drop inlet that catches the runoff from parking lot. It was hard to tell where this storm line went, but it looked like there may have been an underground drainage system underneath the swale. This is an old area of town and we do not have very accurate maps that show the drainage systems. The parking lot and the inlet was clean. No loose trash noticed. The trash cans on site need lids.

ACTION ITEMS: Place lids on the trash containers. Everything else looks good at this park.

Division: Parks – Beverly Community Park **Bldg#/ Area:** _____ **Date:** 09/21/2016
Location: 901 Lumpkin Street, Texarkana, Texas **Time:** 12:50
Inspector: Laura Puckett **Title:** CSI – Administrative Coordinator

Narrative of type facility: This park consist of a Community Center and playground equipment. The entire property surface drains to creek to the west. Most areas have grass established, but there are some bare areas due to tree coverage. There is a swale that has some grass established. This drains directly into creek. There are two trash containers which is plenty for this small park. Parking lot is clean and there was no loose trash noticed. The trash cans at the community center had lids on them, but the two trash containers in the park did not have lids.

ACTION ITEMS: Place lids on the trash containers. Also, make sure the grass clippings do not get blown into creek when mowing.

Division: Parks – Bringle Lake Park **Bldg#/ Area:** _____ **Date:** 09/21/2016
Location: 7602 Bringle Lake Road, Texarkana, Texas **Time:** 11:15
Inspector: Laura Puckett **Title:** CSI – Administrative Coordinator

Narrative of type facility: There are two park areas at Bringle Lake Park. **The West Park** consists of a boat ramp and fish cleaning station. There is a restroom facility, playground equipment and a pavilion on site. The grass in this park is well established and surface drains to the lake. The Boat ramp and parking lot are clean. There is no trash or silt noticed in the lake. The lake water looks very clean. The trash containers at the fish cleaning station and the restroom trash container need lids. There is no trash noticed anywhere in this park.

ACTION ITEMS: Place lids on trash containers at the fish cleaning station and restroom facility.



Narrative of type facility: **The East Park** consists of a restroom facility, playground equipment and a pavilion on site. There is some grass established in this park. However, there are bare spots because of tree coverage. This park is very shady and will not get much sun. So it will be hard to get grass to grow. The surface drains to the lake. The lake bank is well establish with grass and shrubbery that will help with runoff. No silt or trash noticed in the lake at this site. The lake water is very clear and clean. The trash containers have lids and there is no trash notice on the ground or in the parking lot. There is very little silt in the parking lot from the hillside. Grass is has been established on this hillside and there is a rock at the bottom of the berm. The silt deposit will need to be swept. Overall, this park looks great.

ACTION ITEMS: Clean silt from parking lot.

Division: Parks – Ferguson Park and Senior Center **Bldg#/ Area:** _____ **Date:** 09/21/2016
Location: 3000 Texas Blvd, Texarkana, Texas **Time:** 12:40
Inspector: Laura Puckett **Title:** CSI – Administrative Coordinator

Narrative of type facility: This park consists of small playground and Senior Community Center. This park is a very established green space. All drainage for park surface drains to concrete channel in middle of property. The channel has some grass clippings in it. The parking lot is clean and there is no loose trash present. The trash container near the playground equipment does not have a lid.

ACTION ITEMS: Place a lid on the trash container and make sure that grass clippings are not blown into the channel.

Division: Parks –Findley Park **Bldg#/ Area:** _____ **Date:** 09/21/2016
Location: 410 Findley, Texarkana, Texas **Time:** 10:30
Inspector: Laura Puckett **Title:** CSI – Administrative Coordinator

Narrative of type facility: This park playground equipment, basketball court, and softball field. The surface drainage drains to the creek west of the park. No trash noticed at this site. However, the trash containers do not have lids. The parking lot was clean and no loose trash present.

ACTION ITEMS: Place lids on the trash containers.

Division: Parks – Grady T. Wallace Park **Bldg#/ Area:** _____ **Date:** 09/21/2016
Location: 3419 Leopard Drive, Texarkana, Texas **Time:** 9:45
Inspector: Laura Puckett **Title:** CSI – Administrative Coordinator

Narrative of type facility: This park consists of softball complex, pond, playground equipment, soccer fields, and maintenance facility. The maintenance facility is enclosed where they store tractors, mowers, weed eaters, and other maintenance equipment. All equipment is checked daily for leaks. Maintenance is done at Fleet Services on regular basis. The washing of equipment is also done at Fleet. On some occasions equipment is rinsed off with water on site. There are two dumpsters with closed lids at maintenance facility. There are some recycling containers behind the



dumpster which could probably be stored elsewhere. All drainage is surface drainage through channels, ditches, and swales. Some drains to pond and other drains through channels to culvert underneath highway. The pond is silty red, but the color is not as bad as it was in the past. The banks along the pond have grass established. Most areas in park had grass established except for areas where people park and drive on constantly. The parking lots are clean with no trash noticed. There are plenty of trash containers present throughout park. However, the blue plastic containers do not have lids. None of the trash containers were overflowing. This park is in good shape.

ACTION ITEMS: Place lids on trash cans.

Division: Parks – Karrh Park **Bldg#/ Area:** _____ **Date:** 09/21/2016
Location: 2102 S Ann Street, Texarkana, Texas **Time:** 9:55
Inspector: Laura Puckett **Title:** CSI – Administrative Coordinator

Narrative of type facility: This park consist of playground equipment, pavilion, baseball fields and a pond. All drainage is surface drainage. Most of the park drains to the pond. Some runoff drains to ditches along the south side street. Grass is not established throughout the entire park because of the trees. These areas are limited to places that do not see sunlight. There are a couple of areas along the pond banks that do not have any grass growing because of foot traffic. However, the pond appears to be clean and there is no silt visible. The parking lot is clean and no loose trash is present. There are 25 plus trash containers at this park and not one has a lid. There are two recycling bins near concessions. Overall, park is in good shape.

ACTION ITEMS: Place lids on the trash containers.

Division: Parks – Kidtopia Park **Bldg#/ Area:** _____ **Date:** 09/21/2016
Location: 201 Oak Street, Texarkana, Texas **Time:** 9:15
Inspector: Laura Puckett **Title:** CSI – Administrative Coordinator

Narrative of type facility: Parking for this park is street parking only. All drainage is surface drainage and grass is established. Everything surface drains across park to curb inlet along Elm Street. Stormwater drains through grass before it reaches curb inlet. Curb Inlet is clear of debris. All garbage cans have lids on them and are not overflowing. No loose garbage on ground. This park is under some construction on the west end. A skate park is being erected on the west end of the park. There is current ground disturbance, but is contained with silt fencing. The street is clear of silt. Overall, this park should have very little impact on the stormwater.

ACTION ITEMS: Currently this park is in good shape.



Division: Parks – Scott Joplin Park Bldg#/ Area: _____ Date: _____
09/21/2016
 Location: 1621 West Street, Texarkana, Texas Time: 10:00

Inspector: Laura Puckett Title: CSI – Administrative Coordinator

Narrative of type facility: Park consists of playground equipment, pavilion, and bathroom. All drainage is surface drainage that drains to natural creek runs through the middle of property. The creek has standing water which is clear. Parking lots is clear of debris. There were a lot of pine needles, etc. in the parking lot. Trash cans present but no lids on them. If we receive funding, I believe Dusty Henslee recommended doing some work along the creek in this area to help with the erosion problem by either lessening the slopes or adding rock gabions to the sides. There are approximately six trash containers on this property and do not have lids.

ACTION ITEMS: In the future as funds allow do the recommended work along the creek. Place lids on the trash containers.

Division: Parks – Spring Lake Park Bldg#/ Area: _____ Date: 09/21/2016
 Location: 4303 North Park Road, Texarkana, Texas Time: 12:00
 Inspector: Laura Puckett Title: CSI – Administrative Coordinator

Narrative of type facility: This park consists of baseball field complex, lake, college baseball and softball fields, playground, pavilions, maintenance building, detention ponds, old swimming pool site and dog park. The maintenance facility is enclosed and tractors, mowers, weed eaters, and other maintenance equipment are stored on site. They check daily for leaks. Maintenance is done at Fleet Services on regular basis. Washing is also done at Fleet, but on occasion equipment is rinsed with water on site. There are two dumpster located at the maintenance building and small amounts of trash on the ground around them. All drainage in park is surface drainage that drains to lake and 2 detention ponds before it leaves site. Grass in this park is established with the exception of areas under the thick pine trees, where it does not see the sun. Overflow structure for lake is in good condition.

The baseball complex was in good condition, there are plenty of trash cans (without lids), recycle bins, and grass established. No loose trash was present.

Old swimming pool was demolished and a splash pad was constructed. The splash pad is closed at this time for the season and the water is off. The area is clean and grass is established. The water from the splash pad is contained and recycled.

Old detention pond close to I-30 is in good working condition. Grass is established and the overflow structure is still in good shape.

The parking lot and streets inside park are clean. There are some leaves present. All the blue trash containers need lids. However, they were not overflowing and no loose trash present in park.

Overall this site is in good condition.

ACTION ITEMS: Place lids on all uncovered trash containers.



Division: Parks – Southwest Center Bldg#/ Area: _____ Date: 09/29/2016

Location: 3212 W 7th Street, Texarkana, Texas Time: 9:00

Inspector: Laura Puckett Title: CSI – Administrative Coordinator

Narrative of type facility: This site is the administration office for Parks and Recreation and consists of a small playground and tennis courts. Most runoff drains on the surface to a creek to the east. The front lot drains to street inlets. The inlets were clean. The parking lot is clean. Not trash or debris noticed. Grass is established throughout with the exception of an area under the pine trees where it does not get much sun. There is a trash dumpster on site on the west side of the building which is not overflowing. There is one trash container located at the entrance of the tennis courts. It does not have a lid, but is not overflowing. This site is in great shape.

ACTION ITEMS: Place lids on all uncovered trash containers.

Overall, the Parks & Recreation Department do not pose a threat to contributing to any illicit discharge into the MS4 at present time. However, at this time, I am requesting that the Parks & Recreation Department place lids on all trash containers to prevent any overflow of trash onto the ground and into the MS4.



User Login

[Home](#) » [Login](#)

Login Here

Username
Password

[Forgot password?](#)

[Login](#)

Contractors, create an account

If you are a contractor, you can easily create an account by clicking the link below.

[Create an account!](#)

Please note that you must first be placed into the system by a participating agency in order to create an account.

Related Links

- [Terms of Service](#)
- [Privacy Policy](#)
- [Service Level Agreement](#)
- [Support Policy](#)
- [Security Information](#)



This is a secure page. Each secure page you view will be encrypted before being transmitted. [See for yourself](#)



For additional security, speed and reliability, please use this free Chrome web browser. [Click here to download](#)



Home



To Do List For ...
Laura Puckett



Public Works/Parks & Rec



My Pending Requests 1
My Projects



Contractor Registration



My Applications 0
My Inspections 0
My Notices 0



Permits and Inspections



To Do
Reviews - In Review 276
Reviews - Items Required 18
Archive Projects 109

Warnings
Expiring Projects 90
Holding Projects 1
Over Warnings 6



Code Enforcement



My Pending Requests
My Cases 104
Review - File Lien 7
Review - Invoices Received 51
Review - Record Filing 1
Schedule Demolition 4
Verify Abatement 1
CLOSING 41

Power Carwash/ Mobile Cleaning Business

Car-wash and mobile power washing water contains chemicals and sediment that, if released, can contaminate drinking water supplies and block sewer lines, damage pumps, and upset the proper treatment of wastewater and/or pollute the MS4 Municipal Separate Storm Sewer System. The following steps will help keep your business in compliance and keep our community's water supply safe:

- Check to see if you need a Permit.
- Use biodegradable and non-toxic cleaning products as well as phosphorous free soap. (Cleaning products labeled "nontoxic" and "biodegradable" can still harm wildlife if they enter a storm drain system.) Some examples are: Green Earth Technologies Car Wash; Eco Touch Waterless Car Wash; and Simple Green Wash and Wax.
- Store, recycle, and dispose of all wastes to avoid spills or releases. You are responsible for the proper management of any waste from the time the waste is generated through final disposal.
- Take appropriate precautions and obtain required registrations related to any fuel tanks at your site.
- Use best management practices to ensure a clean and healthful car wash for your customers, employees and the environment.
- Filter the dirty wash water before it enters the storm sewer system. Catch basins and sand and grit traps can serve this purpose.
- Check with Texarkana Water Utilities at 903-798-3800 to inquire about discharging wash water into the sanitary sewer system.

You are in violation if:

Any wastewater from a commercial/mobile power washer or from the washing or other cleaning of a building exterior that contains any soap, detergent, degreaser, solvent, or any other harmful cleaning substance enters a storm drain.

Stormwater

Stormwater is rain and snow melt which runs across the ground "runoff" picking up pollutants like sediment, soap, pet waste, chemicals, fertilizers, etc. and drains into the inlets, storm drains, streams, creeks, lakes and rivers. This stormwater "runoff" is not cleaned or filtered in anyway. Therefore, if anything except rain goes down the inlets, storm drains, streams, creeks, lakes and rivers may contaminate our drinking water.

See the back for relevant sections of the ordinance

The City of Texarkana, Texas
Stormwater Management
919 Elm Street
Phone: 903-798-3948 Fax: 903-792-6419
dustin.herridge@bckusa.org or laura.puckett@bckusa.org

Sec. 125-34. - Specific prohibitions and requirements.

The specific prohibitions and requirements in this section are not inclusive of all the discharges prohibited by this chapter.

- (a) No person shall recklessly introduce or cause to be introduced into the MS4 any discharge that causes or contributes to causing the city to violate a water quality standard, the city's TPDES permit, or any other discharge permit for discharges from its MS4.
- (b) It shall be a violation of this chapter for any person to intentionally deposit, discharge, dispose, drain, dump, emit, empty, leak, leach, pump, pour, spill, throw or otherwise introduce or cause to be introduced into the MS4, or any storm sewer manhole, catch basin, private drain, ditch, street, gutter, creek, stream, tributary, or any other drainage device which connects with or drains into the MS4, any of the following described materials or substances within the city limits:
- (6) Any wastewater from a commercial carwash facility; from any vehicle washing, cleaning, or maintenance at any new or used automobile or other vehicle dealership, rental agency, body shop, repair shop, maintenance facility, or automotive related facility; or from any washing, cleaning, or maintenance of any business or commercial or public service vehicle, including a truck, bus or heavy equipment, by a business that operates more than two (2) such vehicles.
- (7) Any wastewater from a commercial mobile power washer or from the washing or other cleaning of a building exterior that contains any soap, detergent, degreaser, solvent, or any other harmful cleaning substance.

Ordinance Chapter 125-93. Penalty. You could be subject to a fine of not more than \$2,000.00 per violation, per day, or any greater fine authorized by law. Each day, or portion of a day, for which a violation occurs shall constitute a separate violation.



The City of Texarkana, Texas
Stormwater Management
819 Elm Street
Phone: 903-798-3948 Fax: 903-792-6419
dustin.herridge@bckusa.org or laura.puckett@bckusa.org



The City of Texarkana, Texas
Stormwater Management
919 Elm Street
Phone: 903-798-3948 Fax: 903-792-6419
dustin.herridge@bckusa.org or laura.puckett@bckusa.org

PSA - Plays before movies in the Park 2014



Stormwater Commercial



City of Texarkana, Texas

Subscribe 33

23 views

+ Add to Share ... More

Like 0 Dislike 0



Stormwater Commercial



City of Texarkana, Texas

Subscribe 33

23 views



Stormwater Commercial



City of Texarkana, Texas

Subscribe 33

23 views

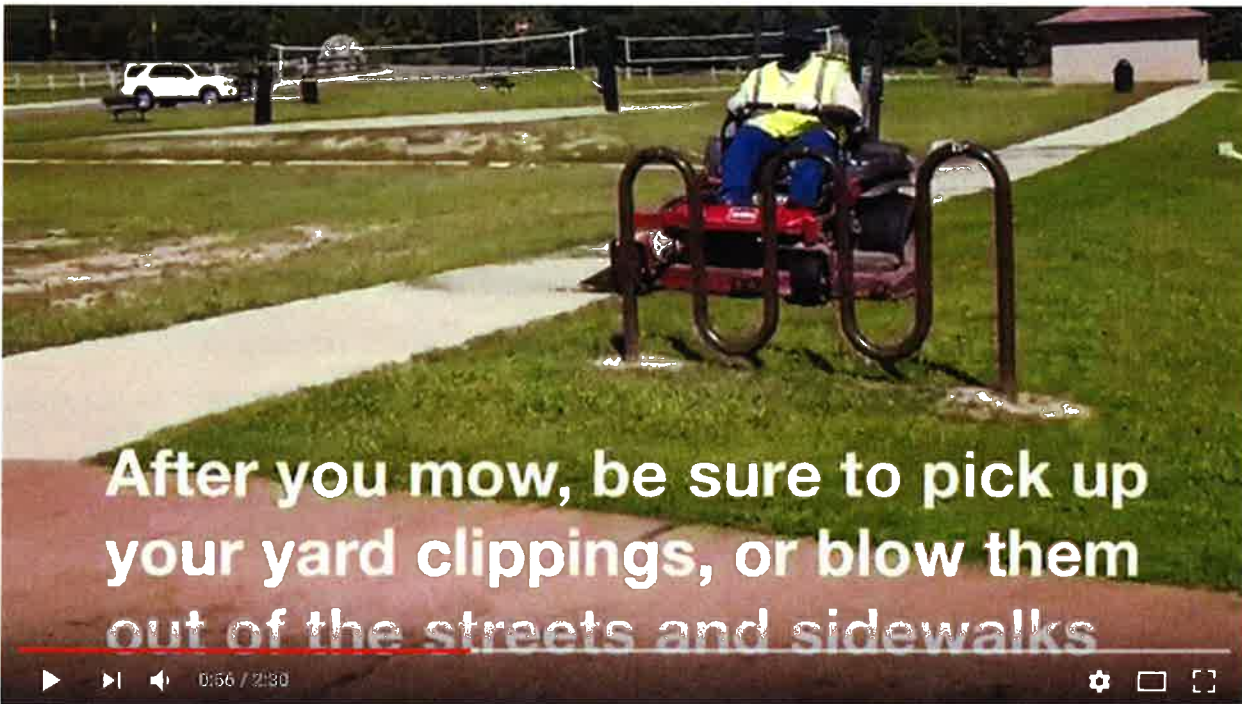

Stormwater Commercial



City of Texarkana, Texas

Subscribe 33

23 views



Stormwater Commercial

 City of Texarkana, Texas
[Subscribe](#) 33

23 views

+ Add to ➦ Share ... More

👍 0 🗨️ 0

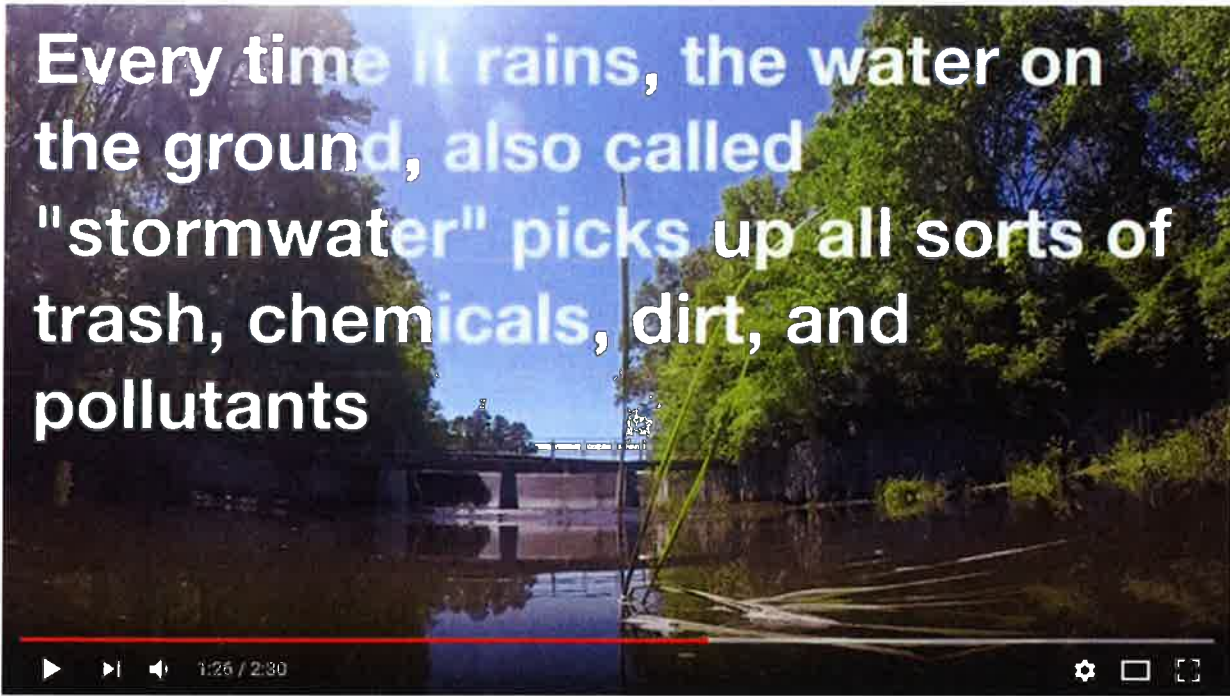

Stormwater Commercial

 City of Texarkana, Texas
[Subscribe](#) 33

23 views

+ Add to ➦ Share ... More

👍 0 🗨️ 0



Stormwater Commercial



City of Texarkana, Texas

Subscribe 33

23 views



Stormwater Commercial



City of Texarkana, Texas

Subscribe 33

23 views

+ Add to Share ... More

0 0



Adopt- A-Spot Program Agreement

Streets Parks Medians Lots Blocks Trails Alleys Hydrants
 Cemetery Plots Waterways Storm Water Drains Landscaping Features

The following is a Letter of Agreement between the City of Texarkana, Texas, hereinafter called the "City", and

Texarkana Alumni Chapter of Kappa Alpha Psi Fraternity, Inc

Hereinafter called the "Sponsor", recognizing the need and the desirability of a beautiful, litter-free community; and are entering this Agreement to permit the Sponsor to provide volunteer services at least four (4) times per year at the specific site known as

College Dr to Eddings Ave - Lincoln Avenue

By signatures below, the Sponsor, both jointly and severally, acknowledge the potentially dangerous nature of the work and agree to the following terms and conditions:

- The Sponsor shall be required to adopt for a minimum period of two years.
- The Sponsor shall volunteer at the location a **minimum of four times a year**. It is desired that one of these days coincide with the Citywide Cleanup campaign in the spring and fall of each year. Monthly volunteering is encouraged, when possible.

Required: Litter Cleanup

Optional: (Place check by desired activities)

- Maintain Flower Bed/Landscaping
- Mow Grass. If yes, how often: _____
- Special Project: _____

- The Sponsor shall appoint or select a chairperson to serve as spokesperson for the Sponsor, who will be responsible for recording and reporting the volunteer hours worked and number of bags collected on cleanups to the City.
- The Sponsor and participants agree to abide by all laws, regulations, and guidelines relating to safety.
- The Sponsor shall be responsible for maintain a first-aid kit and adequate drinking water while volunteering on the adopted section.
- The Sponsor shall be responsible for prohibiting participants from either possessing or consuming alcoholic beverages while volunteering on the adopted section.
- The Sponsor shall ensure that individuals participating in a volunteer effort shall wear bright colored clothing or safety vests.
- If participants are 15 or younger, the Sponsor shall furnish adequate supervision by one or more adults.
- The Sponsor shall not subcontract or assign its duties or responsibilities to any other Sponsor organization, or enterprise without first consulting with the City of Texarkana, Texas.
- The Sponsor shall have the option of renewing the agreement subject to the approval of the City.
- The Sponsor shall report volunteer activities and hours on approved forms provided by the City of Texarkana. After each cleanup, these forms should be mailed to the Public Works Department at PO

Box 1967, Texarkana, Texas 75504. A copy may be emailed to dustin.henslee@txkusa.org in lieu of mailing.

The City agrees to accomplish the following:

- Work with the Sponsor to determine the specific section to be adopted.
- Place a sign identifying the adopted section with the Sponsor's name or acronyms displayed. The Public Works Department must approve additional or customized signage.
- Remove litter from the adopted section under unusual circumstances, i.e. remove large, heavy, or hazardous items.
- Continue to provide current level of maintenance.

If, in the sole judgment of the City, it is found that the adopting Sponsor is not meeting the terms and conditions of this agreement, upon 30 days' notice, the City may terminate the adopting agreement and remove the signs. This agreement may be modified in scope or altered in any other manner at the sole discretion of the City. The City reserves the right to modify or cancel the Adoption Program at any time and for any reason, at the sole discretion of the City. It is also agreed that the City does not assume liability for the actions of the Sponsor in performing maintenance on City property. This agreement may be amended at any time by mutual agreement of both the City and the Sponsor.

This agreement shall commence on the date listed by the Sponsor below and shall endure until such time as terminated by either the Sponsor or the City.

Printed Name of Sponsor <i>TEXARKANA Alumni Chapter Kappa Alpha Psi</i>	Sponsor Mailing Address <i>4902 Lesley Ln Texarkana, TX 75503</i>
Printed Name of Chairperson <i>Malcolm Baker</i>	Chairperson Mailing Address <i>2412 Mamie Dr Texarkana, TX 75501</i>
Primary Phone Number <i>903-691-4429</i>	Secondary Phone Number
Email Address <i>drmacc1@yahoo.com</i>	Sponsor Website
Chairperson Signature <i>[Signature]</i>	Date <i>11/14/16</i>
City of Texarkana, Texas PW Representative Signature <i>[Signature]</i>	Date <i>11-16-16</i>

Please Return to:

City of Texarkana, Texas Public Work Department

Address: PO BOX 1967, Texarkana, Texas 75504-1967

Phone: 903-798-3948 **Fax:** 903-792-6419 **Email:** dustin.henslee@txkusa.org

VOLUNTEER ACTIVITY REPORT INSTRUCTIONS



Use a separate sheet for each department. Please photocopy as needed.

❖ **REPORTING VOLUNTEERS**

At the beginning of each month, list the volunteers as of the first day of the month. At the end of the list add any volunteers added during the month.

❖ **TYPES OF VOLUNTEERS**

For each volunteer, indicate in the "Type" column which volunteer category the volunteer falls under. Use the following legend:

Fire	7704V	-	Firefighters
Police	7720V	-	Police Reserve
Police	8888V	-	Police Reserve-Motorcycle
EMS	7720E	-	Ambulance, EMS
Inside	8724I	-	Inside Volunteer
Outside	3724O	-	Outside Volunteer
Elected/Appointed Officials	8742E*	-	Governing Board Only
Elected/Appointed Officials	8742F*	-	Governing Board and all Appointed Boards and Commissions

If you do not have a separate EMS department and your firefighters double as EMTs, they will be rated as firefighters.

*The equivalent payroll for these volunteers will be based on \$600 per official per year or the actual payroll, whichever is greater.

❖ **RECORDING DAILY ACTIVITY & FIGURING EQUIVALENT PAYROLL**

You have two options when reporting the daily activity of the volunteer.

1. Checking off the date worked - If you choose to use each day worked, the equivalent payroll for each volunteer will be \$110 per each week in which any days were worked.
2. Indicating how many *hours* worked each day - If you choose to use the number of hours worked each day, the payroll equivalent will be based on an hourly wage. For example, a police reserve working 3 hours would be figured by multiplying 3 times an assumed hourly rate of \$9.90, thus the equivalent payroll would be \$29.70. Should this equivalent payroll figure exceed \$110 per volunteer in any week, it will be limited to \$110 for that week.

HOURLY FIGURES TO BE USED TO DETERMINE PAYROLL EQUIVALENTS**

Firefighters:	\$11.00 per hour
EMS:	\$9.25 per hour
Police Reserves:	\$9.90 per hour
Inside/Outside:	Minimum Wage (currently \$7.25 per hour)

❖ **KEEPING THIS RECORD**

Keep this report to be used for the Workers' Compensation Audit. It should be retained for a minimum of five years. Do not send the report to TML Intergovernmental Risk Pool unless requested. You will need this information to verify volunteer activity for your audit. **Should this information not be available, the maximum \$5,720 equivalent payroll for each volunteer will be used (\$110 x 52 weeks).**

** Volunteers whose equivalent payroll is calculated based on the above hourly/weekly rates are eligible to receive the minimum weekly indemnity benefit (currently \$127.00). The Pool offers higher benefit options. For more information, please see the attached Volunteer Activity Report Supplement - Optional Income Benefits.

If you have any questions about completing this form, call the Underwriting Department at (800) 537-6655.



TEXARKANA

Adopt- A-Spot Program Agreement

Streets Parks Medians Lots Blocks Trails Alleys Hydrants
Cemetery Plots Waterways Storm Water Drains Landscaping Features

The following is a Letter of Agreement between the City of Texarkana, Texas, hereinafter called the "City", and

Believe in Beverly Neighborhood Association & James Aaron

Hereinafter called the "Sponsor", recognizing the need and the desirability of a beautiful, litter-free community; and are entering this Agreement to permit the Sponsor to provide volunteer services at least four (4) times per year at the specific site known as

Beverly Community Garden

By signatures below, the Sponsor, both jointly and severally, acknowledge the potentially dangerous nature of the work and agree to the following terms and conditions:

- The Sponsor shall be required to adopt for a minimum period of two years.
- The Sponsor shall volunteer at the location a **minimum of four times a year**. It is desired that one of these days coincide with the Citywide Cleanup campaign in the spring and fall of each year. Monthly volunteering is encouraged, when possible.

Required: Litter Cleanup

Optional: (Place check by desired activities)

Maintain Flower Bed/Landscaping

Mow Grass. If yes, how often: _____

Special Project: _____

- The Sponsor shall appoint or select a chairperson to serve as spokesperson for the Sponsor, who will be responsible for recording and reporting the volunteer hours worked and number of bags collected on cleanups to the City.
- The Sponsor and participants agree to abide by all laws, regulations, and guidelines relating to safety.
- The Sponsor shall be responsible for maintain a first-aid kit and adequate drinking water while volunteering on the adopted section.
- The Sponsor shall be responsible for prohibiting participants from either possessing or consuming alcoholic beverages while volunteering on the adopted section.
- The Sponsor shall ensure that individuals participating in a volunteer effort shall wear bright colored clothing or safety vests.
- If participants are 15 or younger, the Sponsor shall furnish adequate supervision by one or more adults.
- The Sponsor shall not subcontract or assign its duties or responsibilities to any other Sponsor organization, or enterprise without first consulting with the City of Texarkana, Texas.
- The Sponsor shall have the option of renewing the agreement subject to the approval of the City.
- The Sponsor shall report volunteer activities and hours on approved forms provided by the City of Texarkana. After each cleanup, these forms should be mailed to the Public Works Department at PO



Box 1967, Texarkana, Texas 75504. A copy may be emailed to dustin.henslee@txkusa.org in lieu of mailing.

The City agrees to accomplish the following:

- Work with the Sponsor to determine the specific section to be adopted.
- Place a sign identifying the adopted section with the Sponsor's name or acronyms displayed. The Public Works Department must approve additional or customized signage.
- Remove litter from the adopted section under unusual circumstances, i.e. remove large, heavy, or hazardous items.
- Continue to provide current level of maintenance.

If, in the sole judgment of the City, it is found that the adopting Sponsor is not meeting the terms and conditions of this agreement, upon 30 days' notice, the City may terminate the adopting agreement and remove the signs. This agreement may be modified in scope or altered in any other manner at the sole discretion of the City. The City reserves the right to modify or cancel the Adoption Program at any time and for any reason, at the sole discretion of the City. It is also agreed that the City does not assume liability for the actions of the Sponsor in performing maintenance on City property. This agreement may be amended at any time by mutual agreement of both the City and the Sponsor.

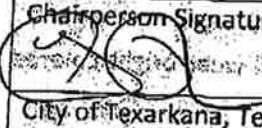
This agreement shall commence on the date listed by the Sponsor below and shall endure until such time as terminated by either the Sponsor or the City.

Printed Name of Sponsor <i>Bellevue in Beverly Neighborhood Association</i>	Sponsor Mailing Address
Printed Name of Chairperson <i>Tyler Ross</i>	Chairperson Mailing Address <i>410 June St. Texarkana TX 75501</i>
Primary Phone Number <i>903-691-4334</i>	Secondary Phone Number
Email Address <i>BellevueInBeverly2016@gmail.com</i>	Sponsor Website
Chairperson Signature 	Date <i>8/28/16</i>
City of Texarkana, Texas PW Representative Signature 	Date <i>9-8-16</i>

Please Return to:

City of Texarkana, Texas Public Work Department

Address: PO BOX 1967, Texarkana, Texas 75504-1967

Phone: 903-798-3948 Fax: 903-792-6419 Email: dustin.henslee@txkusa.org



Adopt- A-Spot Program Agreement

Streets Parks Medians Lots Blocks Trails Alleys Hydrants
Cemetery Plots Waterways Storm Water Drains Landscaping Features

The following is a Letter of Agreement between the City of Texarkana, Texas, hereinafter called the "City", and Growing Season Inc.

Hereinafter called the "Sponsor", recognizing the need and the desirability of a beautiful, litter-free community; and are entering this Agreement to permit the Sponsor to provide volunteer services at least four (4) times per year at the specific site known as _____.

By signatures below, the Sponsor, both jointly and severally, acknowledge the potentially dangerous nature of the work and agree to the following terms and conditions:

- The Sponsor shall be required to adopt for a minimum period of two years.
- The Sponsor shall volunteer at the location a **minimum of four times a year**. It is desired that one of these days coincide with the Citywide Cleanup campaign in the spring and fall of each year. Monthly volunteering is encouraged, when possible.

Required: Litter Cleanup

Optional: (Place check by desired activities)

- Maintain Flower Bed/Landscaping Boxes at 3rd and Texas and along Main in front of Perot
- Mow Grass. If yes, how often: _____
- Special Project: _____

- The Sponsor shall appoint or select a chairperson to serve as spokesperson for the Sponsor, who will be responsible for recording and reporting the volunteer hours worked and number of bags collected on cleanups to the City.
- The Sponsor and participants agree to abide by all laws, regulations, and guidelines relating to safety.
- The Sponsor shall be responsible for maintain a first-aid kit and adequate drinking water while volunteering on the adopted section.
- The Sponsor shall be responsible for prohibiting participants from either possessing or consuming alcoholic beverages while volunteering on the adopted section.
- The Sponsor shall ensure that individuals participating in a volunteer effort shall wear bright colored clothing or safety vests.
- If participants are 15 or younger, the Sponsor shall furnish adequate supervision by one or more adults.
- The Sponsor shall not subcontract or assign its duties or responsibilities to any other Sponsor organization, or enterprise without first consulting with the City of Texarkana, Texas.
- The Sponsor shall have the option of renewing the agreement subject to the approval of the City.
- The Sponsor shall report volunteer activities and hours on approved forms provided by the City of Texarkana. After each cleanup, these forms should be mailed to the Public Works Department at PO



Box 1967, Texarkana, Texas 75504. A copy may be emailed to dustin.henslee@txkusa.org in lieu of mailing.

The City agrees to accomplish the following:

- Work with the Sponsor to determine the specific section to be adopted.
- Place a sign identifying the adopted section with the Sponsor's name or acronyms displayed. The Public Works Department must approve additional or customized signage.
- Remove litter from the adopted section under unusual circumstances, i.e. remove large, heavy, or hazardous items.
- Continue to provide current level of maintenance.

If, in the sole judgment of the City, it is found that the adopting Sponsor is not meeting the terms and conditions of this agreement, upon 30 days' notice, the City may terminate the adopting agreement and remove the signs. This agreement may be modified in scope or altered in any other manner at the sole discretion of the City. The City reserves the right to modify or cancel the Adoption Program at any time and for any reason, at the sole discretion of the City. It is also agreed that the City does not assume liability for the actions of the Sponsor in performing maintenance on City property. This agreement may be amended at any time by mutual agreement of both the City and the Sponsor.

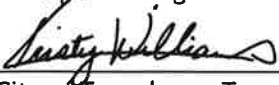
This agreement shall commence on the date listed by the Sponsor below and shall endure until such time as terminated by either the Sponsor or the City.

Printed Name of Sponsor Growing Seasons Inc	Sponsor Mailing Address 3206 New Boston Rd, Texarkana, TX 75501
Printed Name of Chairperson Kristy Williams	Chairperson Mailing Address 106 S. Maple St, New Boston, TX 75570
Primary Phone Number (903)832-7988	Secondary Phone Number (409)658-6624
Email Address kwilliams@growingseasonsnursey.com	Sponsor Website www.growingseasonsnursey.com
Chairperson Signature 	Date 6/21/2016
City of Texarkana, Texas PW Representative Signature 	Date 6-21-16

Please Return to:

City of Texarkana, Texas Public Work Department

Address: PO BOX 1967, Texarkana, Texas 75504-1967

Phone: 903-798-3948 **Fax:** 903-792-6419 **Email:** dustin.henslee@txkusa.org



TEXARKANA

Adopt- A-Spot Program Agreement

Streets Parks Medians Lots Blocks Trails Alleys Hydrants
 Cemetery Plots Waterways Storm Water Drains Landscaping Features

The following is a Letter of Agreement between the City of Texarkana, Texas, hereinafter called the "City", and

Edgewood Manor

Hereinafter called the "Sponsor", recognizing the need and the desirability of a beautiful, litter-free community; and are entering this Agreement to permit the Sponsor to provide volunteer services at least four (4) times per year at the specific site known as

W. 52nd Street

By signatures below, the Sponsor, both jointly and severally, acknowledge the potentially dangerous nature of the work and agree to the following terms and conditions:

- The Sponsor shall be required to adopt for a minimum period of two years.
- The Sponsor shall volunteer at the location a **minimum of four times a year**. It is desired that one of these days coincide with the Citywide Cleanup campaign in the spring and fall of each year. Monthly volunteering is encouraged, when possible.

Required: Litter Cleanup

Optional: (Place check by desired activities)

- Maintain Flower Bed/Landscaping
- Mow Grass. If yes, how often: _____
- Special Project: _____

- The Sponsor shall appoint or select a chairperson to serve as spokesperson for the Sponsor, who will be responsible for recording and reporting the volunteer hours worked and number of bags collected on cleanups to the City.
- The Sponsor and participants agree to abide by all laws, regulations, and guidelines relating to safety.
- The Sponsor shall be responsible for maintain a first-aid kit and adequate drinking water while volunteering on the adopted section.
- The Sponsor shall be responsible for prohibiting participants from either possessing or consuming alcoholic beverages while volunteering on the adopted section.
- The Sponsor shall ensure that individuals participating in a volunteer effort shall wear bright colored clothing or safety vests.
- If participants are 15 or younger, the Sponsor shall furnish adequate supervision by one or more adults.
- The Sponsor shall not subcontract or assign its duties or responsibilities to any other Sponsor organization, or enterprise without first consulting with the City of Texarkana, Texas.
- The Sponsor shall have the option of renewing the agreement subject to the approval of the City.
- The Sponsor shall report volunteer activities and hours on approved forms provided by the City of Texarkana. After each cleanup, these forms should be mailed to the Public Works Department at PO

Box 1967, Texarkana, Texas 75504. A copy may be emailed to dustin.henslee@txkusa.org in lieu of mailing.

The City agrees to accomplish the following:

- Work with the Sponsor to determine the specific section to be adopted.
- Place a sign identifying the adopted section with the Sponsor's name or acronyms displayed. The Public Works Department must approve additional or customized signage.
- Remove litter from the adopted section under unusual circumstances, i.e. remove large, heavy, or hazardous items.
- Continue to provide current level of maintenance.

If, in the sole judgment of the City, it is found that the adopting Sponsor is not meeting the terms and conditions of this agreement, upon 30 days' notice, the City may terminate the adopting agreement and remove the signs. This agreement may be modified in scope or altered in any other manner at the sole discretion of the City. The City reserves the right to modify or cancel the Adoption Program at any time and for any reason, at the sole discretion of the City. It is also agreed that the City does not assume liability for the actions of the Sponsor in performing maintenance on City property. This agreement may be amended at any time by mutual agreement of both the City and the Sponsor.

This agreement shall commence on the date listed by the Sponsor below and shall endure until such time as terminated by either the Sponsor or the City.

Printed Name of Sponsor <i>Edgewood Manor</i>	Sponsor Mailing Address <i>4925 Elizabeth Street, Texarkana Texas 75503</i>
Printed Name of Chairperson <i>Brian Matthews</i>	Chairperson Mailing Address <i>Same</i>
Primary Phone Number <i>(903) 824-2626</i>	Secondary Phone Number
Email Address <i>brian.matthews@pwtexas.net</i>	Sponsor Website <i>www.edgewoodmanornursing.com</i>
Chairperson Signature 	Date <i>07/21/16</i>
City of Texarkana, Texas PW Representative Signature 	Date 7-21-16

Please Return to:

City of Texarkana, Texas Public Work Department

Address: PO BOX 1967, Texarkana, Texas 75504-1967

Phone: 903-798-3948 **Fax:** 903-792-6419 **Email:** dustin.henslee@txkusa.org



CITY OF
TEXARKANA
TEXAS

Adopt- A-Spot Program Agreement

Streets Parks Medians Lots Blocks Trails Alleys Hydrants
Cemetery Plots Waterways Storm Water Drains Landscaping Features

The following is a Letter of Agreement between the City of Texarkana, Texas, hereinafter called the "City", and

TEXARKANA HARLEY DAVIDSON HARLEY OWNERS GROUP

Hereinafter called the "Sponsor", recognizing the need and the desirability of a beautiful, litter-free community; and are entering this Agreement to permit the Sponsor to provide volunteer services at least four (4) times per year at the specific site known as

Walton Drive-Unveristy to U.S. 82

By signatures below, the Sponsor, both jointly and severally, acknowledge the potentially dangerous nature of the work and agree to the following terms and conditions:

- The Sponsor shall be required to adopt for a minimum period of two years.
- The Sponsor shall volunteer at the location a **minimum of four times a year**. It is desired that one of these days coincide with the Citywide Cleanup campaign in the spring and fall of each year. Monthly volunteering is encouraged, when possible.

Required: Litter Cleanup

Optional: (Place check by desired activities)

- Maintain Flower Bed/Landscaping
- Mow Grass. If yes, how often: _____
- Special Project: _____

- The Sponsor shall appoint or select a chairperson to serve as spokesperson for the Sponsor, who will be responsible for recording and reporting the volunteer hours worked and number of bags collected on cleanups to the City.
- The Sponsor and participants agree to abide by all laws, regulations, and guidelines relating to safety.
- The Sponsor shall be responsible for maintain a first-aid kit and adequate drinking water while volunteering on the adopted section.
- The Sponsor shall be responsible for prohibiting participants form either possessing or consuming alcoholic beverages while volunteering on the adopted section.
- The Sponsor shall ensure that individuals participating in a volunteer effort shall wear bright colored clothing or safety vests.
- If participants are 15 or younger, the Sponsor shall furnish adequate supervision by one or more adults.
- The Sponsor shall not subcontract or assign its duties or responsibilities to any other Sponsor organization, or enterprise without first consulting with the City of Texarkana, Texas.
- The Sponsor shall have the option of renewing the agreement subject to the approval of the City.
- The Sponsor shall report volunteer activities and hours on approved forms provided by the City of Texarkana. After each cleanup, these forms should be mailed to the Public Works Department at PO

Box 1967, Texarkana, Texas 75504. A copy may be emailed to dustin.henslee@txkusa.org in lieu of mailing.

The City agrees to accomplish the following:

- Work with the Sponsor to determine the specific section to be adopted.
- Place a sign identifying the adopted section with the Sponsor's name or acronyms displayed. The Public Works Department must approve additional or customized signage.
- Remove litter from the adopted section under unusual circumstances, i.e. remove large, heavy, or hazardous items.
- Continue to provide current level of maintenance.

If, in the sole judgment of the City, it is found that the adopting Sponsor is not meeting the terms and conditions of this agreement, upon 30 days' notice, the City may terminate the adopting agreement and remove the signs. This agreement may be modified in scope or altered in any other manner at the sole discretion of the City. The City reserves the right to modify or cancel the Adoption Program at any time and for any reason, at the sole discretion of the City. It is also agreed that the City does not assume liability for the actions of the Sponsor in performing maintenance on City property. This agreement may be amended at any time by mutual agreement of both the City and the Sponsor.

This agreement shall commence on the date listed by the Sponsor below and shall endure until such time as terminated by either the Sponsor or the City.

Printed Name of Sponsor <i>TEXARKANA Harley Davidson H.O.G.</i>	Sponsor Mailing Address <i>802 WALTON Drive, TEXARKANA, TX</i>
Printed Name of Chairperson <i>Paco Ritter, Director</i>	Chairperson Mailing Address <i>3806 E. CASTLERIDGE Dr., TEXARKANA, AR</i>
Primary Phone Number <i>903-277-5172</i>	Secondary Phone Number
Email Address <i>PACORITTER@CableONE.NET</i>	Sponsor Website
Chairperson Signature <i>Paco Ritter</i>	Date <i>7/23/16</i>
City of Texarkana, Texas PW Representative Signature <i>[Signature]</i>	Date 7-28-16

Please Return to:

City of Texarkana, Texas Public Work Department

Address: PO BOX 1967, Texarkana, Texas 75504-1967

Phone: 903-798-3948 **Fax:** 903-792-6419 **Email:** dustin.henslee@txkusa.org



CITY OF TEXARKANA
invites applications for the position of:

Maintenance Tech I Litter and Debris

SALARY: \$25,100.00 /Year

OPENING DATE: 11/03/16

CLOSING DATE: Continuous

DESCRIPTION:

GENERAL PURPOSE

Assumes responsibility for trash/debris pickup, light mowing and weedeating operations, storm debris cleanup, bad weather assistance, and clean up of City owned properties.

EXAMPLES OF ESSENTIAL DUTIES:

ESSENTIAL DUTIES AND RESPONSIBILITIES

Operators lawn mowers, weedeater, and blowers for purpose of cleaning City property.

Pickup trash/debris and clean up City owned properties.

Perform storm cleanup of trees, limbs, etc. Inclement weather preparations.

Perform routine repairs on assigned equipment.

Performs strenuous manual labor, as necessary.

Performs all other duties as assigned by the Street Superintendent or Assistant Street Superintendent.

TYPICAL QUALIFICATIONS:

DESIRED MINIMUM QUALIFICATIONS

Education and Experience:

1. Graduation from high school or GED equivalent.
2. Three (3) years experience in the safe and efficient operation of lawn mowers, weed eaters.

Necessary Knowledge, Skills, and Abilities:

(a) Working knowledge of the hazards and safety precautions common to municipal maintenance and repair activities; working knowledge of the practices, methods, materials, and tools used in modern equipment maintenance.

(b) Skill in the operation of listed tools and equipment.

(c) Ability to maintain effective preventive maintenance programs; ability to establish and maintain effective working relationships with employees, supervisors, and the public.

Special Requirements

A valid Commercial Driver's License with no restrictions, or the ability to obtain one within sixty (60) days.

TOOLS AND EQUIPMENT USED

- 3.
- 4.
- 5.
- 6.
- 7.
- 8.
- 9.

Power and hand tools, and equipment for vehicle and mechanical system work; tools required for minor repairs and maintenance of lawn mowers and weed eaters.

SUPPLEMENTAL INFORMATION:**PHYSICAL DEMANDS**

The physical demands described here are representative of those that must be met by an employee to successfully perform the essential functions of this job. Reasonable accommodations may be made to enable individuals with disabilities to perform the essential job functions.

While performing the duties of this job, the employee is frequently required to use hands to finger, handle, feel, or operate objects, tools, or controls; and reach with hands and arms. The employee is occasionally required to climb or balance; stoop, kneel, crouch, or crawl.

The employee is occasionally required to frequently lift and/or move up to one hundred (100) pounds. The employee is occasionally required to walk, sit, talk, or hear. Specific vision abilities required by this job include close vision, color vision, distance vision, peripheral vision, depth perception, and the ability to adjust focus.

WORK ENVIRONMENT

The work environment characteristics described here are representative of those an employee encounters while performing the essential functions of this job. Reasonable accommodations may be made to enable individuals with disabilities to perform the essential functions.

While performing the duties of this job, the employee frequently works in outside weather conditions. The employee occasionally works near moving mechanical parts; and is occasionally exposed to wet and/or humid conditions, fumes, or

airborne particles, toxic or caustic chemicals, extreme cold, extreme heat, and vibration. The noise level in the work environment is usually quiet in the office and moderately noisy in the field.

APPLICATIONS MAY BE FILED ONLINE AT:
<http://www.ci.texarkana.tx.us>

Position #00106
MAINTENANCE TECH I LITTER AND DEBRIS
JS

P.O. Box 1967
Texarkana, TX 75504
903-798-3917

Maintenance Tech I Litter and Debris Supplemental Questionnaire

- * 1. Do you have a high school diploma or GED equivalent?
 - Yes
 - No
- * 2. Do you have the ability to lift and/or move up to one hundred (100) pounds?
 - Yes
 - No
- * 3. Do you have a valid State drivers' license with a good driving record?
 - Yes
 - No
- * 4. Do you have a valid Commercial Driver's License without any restrictions? (No restrictions allowed)
 - Yes
 - No
- * 5. If you do have a valid Commercial Driver's license without any restrictions, provide state, number and class.
- * 6. If you do not currently have a valid commercial driver's license, would you be able to obtain one within sixty (60) days of employment?
 - Yes
 - No
- * 7. Describe your experience performing strenuous manual labor. Include past employers from which you obtained this experience.
- * 8. Select all tools and equipment you have experience using.
 - Weedeater
 - Push Mower
 - Zero Turn Mower
 - Blower
- * 9. Describe your experience in the operation of power and hand tools.
- * 10. Do you have working knowledge of the practices, methods, materials, and tools used in modern equipment maintenance?
 - Yes
 - No
- * 11. Applications will be reviewed using past work experience. Have you provided detailed information describing your past work experience

Yes No

- * 12. Describe your experience performing storm cleanup of trees, limbs, etc.

- * 13. Describe your experience with inclement weather preparations.

- * 14. Do you have three (3) years experience in the safe and efficient operation of lawn mowers and weed eaters?

- * 15. If so, provide the company name you received this experience from.

- * Required Question

Swimming Pool Application

919 Elm St., Texarkana, TX 75501

Public Works Phone 903-798-3948 Inspections 903-798-3912

➤ Please submit 2 sets of construction plans and 2 sets of site plans with your application.

Residential Pool Commercial Pool Heated Unheated
Existing Fence Yes No Amount of Land Disturbed (Acres): 756 Sq. Ft.

Job Address: 3418 WESLEY ARRON DRIVE TEXARKANA, TEXAS 75503

Property Legal Description: Subdivision/Lot/Block: Lot 3 Block 1 ~~Heritage Grand~~ ^{Aaron Addition} 2nd Addition

Description of Work: Build inground Pool 0804 SHANE @ CABL&ONE, INC

Name of applicant: Billy LEE Phone: 903-701-3201

Contact person: Applicant Property Owner Contractor

Property Owner:

Name: GARRY & RENEE HEINTSCHAL

Address: 3418 WESLEY ARRON DRIVE TEXARKANA, TEXAS 75503

Phone: (903) 832-7400 Fax: () _____ Work E-mail: _____

Contractor:

Name: Billy LEE

Address: 3106 BUCHANAN LOOP RD. TEXARKANA, TEXAS 75501

Phone: (903) 793-8369 Fax: () _____ Work E-mail: _____

Please list all subcontractors that will perform work on this permit.

Electric: Name: DENNIS BAYLESS

Address: _____

Phone: (903) 280-4786 Fax: () _____ Work E-mail: _____

Plumbing: Name: GARY COURTNEY

Address: 5823 SOUTH KINGS HWY.

Phone: (903) 792-5477 Fax: () _____ Work E-mail: _____

I certify that the information on this form and the attached plans is true, complete and accurate to the best of my/our knowledge and belief. If granted this permit, I agree to abide by the conditions of the approved City of Texarkana, Texas Stormwater Management Ordinance and/or the Storm Water Pollution Prevention Plan (SWP3).

NAME AND OFFICIAL TITLE (TYPE OR PRINT)	TELEPHONE NUMBER WITH AREA CODE
SIGNATURE	DATE SIGNED

3418 Wesley
Arroyo Dr

1" = 30'

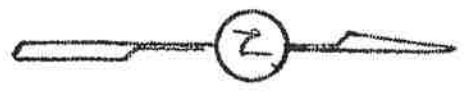

MANOR SECOND ADDN.
VOL. 863, PG. 5

HAROLD
VOL. 343

AARON
PG. 280

56°00'00" W
13' CONC DRIVE

189.06

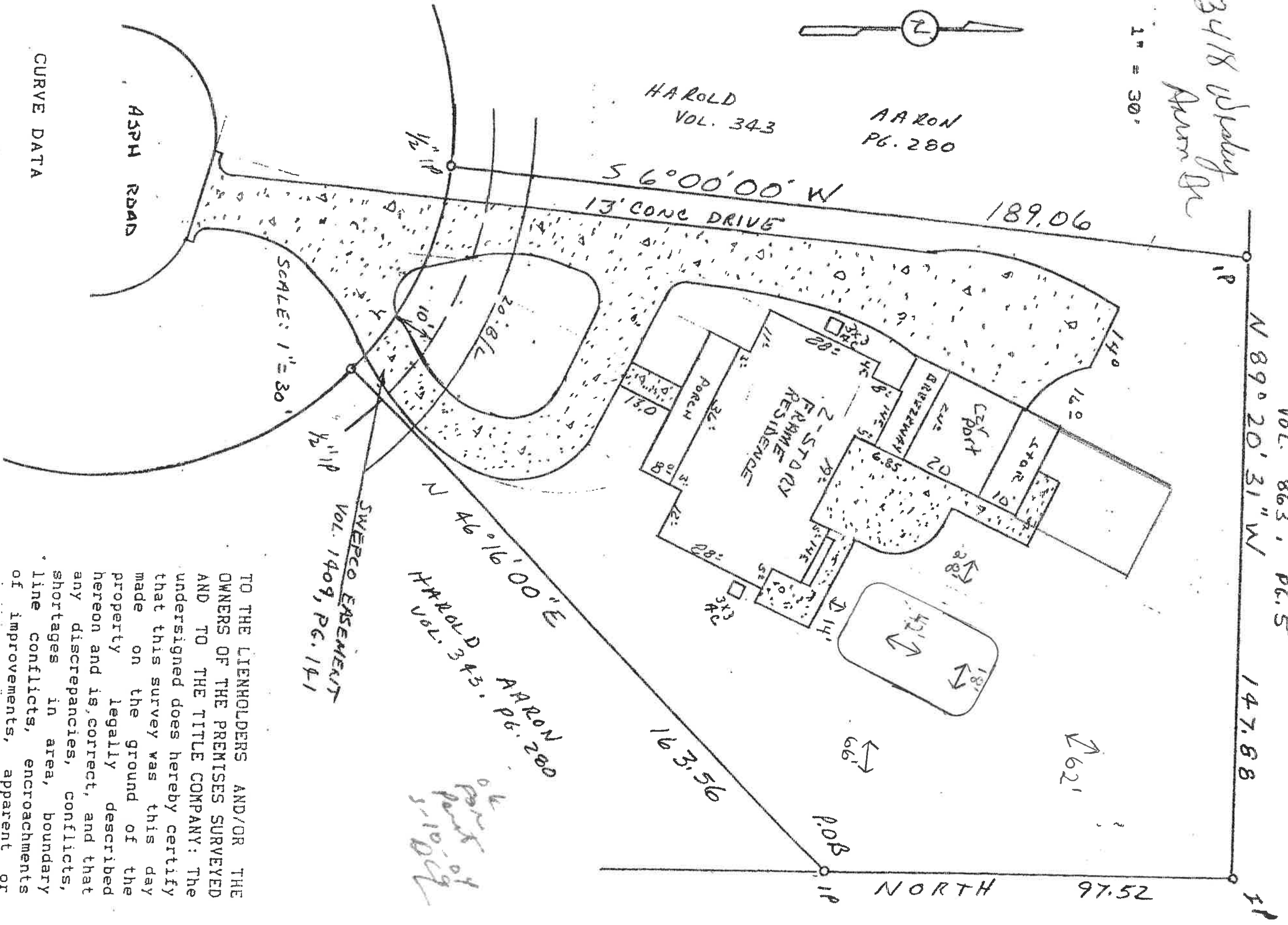

CURVE DATA

HOME OWNER
GARRY + RENISE HEINTSCHL
3418 WESLEY ARROYO DRIVE
TEXARKANA, TEXAS 75503

VACATION POOLS LLC.
OWNER BILLY LEE
3106 BUCHHANN LOOP RD
TEXARKANA, TEXAS 75501

18' x 42' Inground Pool
Est. Coet #36, D00000

TO THE LIENHOLDERS AND/OR THE OWNERS OF THE PREMISES SURVEYED AND TO THE TITLE COMPANY: The undersigned does hereby certify that this survey was this day made on the ground of the property legally described hereon and is, correct, and that any discrepancies, conflicts, shortages in area, boundary line conflicts, encroachments of improvements, apparent or

PLEASANT GROVE ISD.
VOL. 720, PG. 707



CITY OF
TEXARKANA
Public Works Department TEXAS

919 Elm Street
Texarkana, TX 75501
Phone (903) 798-3948
Fax (903) 792-6419

PUBLIC WORKS STORMWATER MANAGEMENT DIVISION
STOP WORK ORDER

Date: April 14, 2016

William Davis Revocable Trust
6822 Summerhill Rd.
Texarkana, Texas 75503

Project/Site Address: Arista Apartments

A **"STOP WORK"** order is being posted on this property effective **IMMEDIATELY**.

Whereas, Violations of Chapter 125 (Stormwater Management Ordinance) have been found at the above referenced site, it is hereby ordered in accordance with the above Code that all persons cease, desist from, and **STOP WORK** at once pertaining to all construction or grading alterations on the above premises, except that work which is necessary for correction of the violations listed below.

This violation is due to failure to comply with the City of Texarkana, Texas Stormwater Ordinance. In order to release this order, the following violations must be addressed immediately.

Nature of Violation(s)/Corrective Actions Required:

1. Clean streets of silt.
2. Install/Reinstall and maintain BMPs.
3. Clean entrance and parking lot of TEXAR located 3525 Stoneledge Blvd.

No additional work shall proceed until the City of Texarkana, Texas Stormwater Management Division inspects and approves the repairs contained in the Stop Work Order. Any activity other than work leading to compliance with this Stop Work Order will result in the issuance of a criminal penalty in an amount not to exceed **\$2,000/day for each violation, or any greater criminal penalty authorized by State law and City Code Chapter 125-93**. Failure to comply with this Stop Work Order shall be deemed justification for cancellation of the Stormwater Permit. Under no circumstances shall verbal permission, given at any time by any person, be considered justification for any work to be performed or any deviation from approved plans to be made which violates any of these regulations.

Please send the corrected actions to the mailing address above, or you may email it to me at the address listed below. If you have questions concerning this violation you can contact our office at 903-798-3948.

Signed by:

Laura Puckett, Administrative Coordinator
E:mail: laura.puckett@txkusa.org

Enclosures

**cc: Shirley Jaster, Assistant City Manager
Kyle Dooley, Director of Public Works
Dusty Henslee, City Engineer
Lynn Henry, Chief Building Official
Cynthia Foster, Administrative Assistant**









3515 Arista Blvd. Texarkana, TX 75503 • 903-255-7869

April 18, 2016

Laura Puckett
Administrative Coordinator
City of Texarkana, Texas
Public Works Department

RE: Stop Work Order

Dear Ms. Puckett,

In regards to your letter dated April 14, 2016, concerning the dirt in the street at Arista Apts. Construction site. I became aware last Tuesday the 12th of this situation and that the sub-contractors had run over the silk fence barrier in several places.

As of the 12th, I ordered a street sweeper from United Rental, which broke down on the 13th after delivery. I ordered the parts and received them Friday to repair the sweeper. The same day I received your registered letter, by that time I had the street cleaned and called you at 4 pm to inspect, at which time I was informed you were off work.

On the 16th the sub-contractors put up a double silk screen fence around the property. On Monday the 18th I surveyed the property and I saw the silk fence was leaking brown water underneath. The street did have a small amount of brown water. I sent maintenance to repair the leaking fence. However, it was noticed that quite a bit of muddy water is coming off of the 10 acres west of my property and flowing down the street. I believe the property belongs to Pat Keaton.

The rented sweeper is running fine now and I will keep cleaned up any dirt that gets into the street daily and watch for any leaks in the fence.

I have informed the sub-contractor not to run over the fence again or they will be terminated.

The supervisor for this project is Mr. Ralph Whittney of Shreveport, LA. I have notified him of the problem and to get control of the subs. If you have any questions for him he can be reached at 870-898-8373 or fax 318-746-9175.

I, William Davis, intend to cooperate fully 110% with you on keeping the street clean. You can reach me at 903-280-3357.

Sincerely,

William Davis

Arista Apartment Homes



CITY OF
TEXARKANA
Public Works Department
TEXAS

919 Elm Street
Texarkana, TX 75501
Phone (903) 798-3948
Fax (903) 792-6419

PUBLIC WORKS STORMWATER MANAGEMENT DIVISION

STOP WORK ORDER

Date: May 3, 2016

RG2 Construction LLC
Ronnie Green
6907 E 9th Street
Texarkana, Arkansas 71854

Project/Site Address: 6908 Woodmere Ct.

A **"STOP WORK"** order is being posted on this property effective **IMMEDIATELY**.

Whereas, Violations of Chapter 125 (Stormwater Management Ordinance) have been found at the above referenced site, it is hereby ordered in accordance with the above Code that all persons cease, desist from, and **STOP WORK** at once pertaining to all construction or grading alterations on the above premises, except that work which is necessary for correction of the violations listed below.

This violation is due to failure to comply with the City of Texarkana, Texas Stormwater Ordinance. In order to release this order, the following violations must be addressed immediately.

Nature of Violation(s)/Corrective Actions Required:

1. Stormwater Permit has not been approved.

No additional work shall proceed until the City of Texarkana, Texas Stormwater Management Division inspects and approves the repairs contained in the Stop Work Order. Any activity other than work leading to compliance with this Stop Work Order will result in the issuance of a criminal penalty in an amount not to exceed **\$2,000/day for each violation, or any greater criminal penalty authorized by State law and City Code Chapter 125-93**. Failure to comply with this Stop Work Order shall be deemed justification for cancellation of the Stormwater Permit. Under no circumstances shall verbal permission, given at any time by any person, be considered justification for any work to be performed or any deviation from approved plans to be made which violates any of these regulations.

Please send the corrected actions to the mailing address above, or you may email it to me at the address listed below. If you have questions concerning this violation you can contact our office at 903-798-3948.

Signed by: 
Laura Puckett, Administrative Coordinator
E: mail: www.laura.puckett@txkusa.org

Enclosures

**cc: Shirley Jaster, Assistant City Manager
Kyle Dooley, Director of Public Works
Dusty Henslee, City Engineer
Lynn Henry, Chief Building Official
Cynthia Foster, Administrative Assistant**



Tuesday, May 3, 2016 12:23:45
6910 Woodmere Ct, Tarkenton TX 75503 United States



MEMO

TO: FILE
FROM: LAURA PUCKETT
DATE: Monday, October 10, 2016
RE: MHC Kenworth – Illicit Discharge at 912 East Loop Drive

Today, I went on an environmental/stormwater call with TWU's, Patrick Reed. Inspected the lift station on site at MHC Kenworth which was not operating properly and has overflowed into the environment. A PVC pipe was found to be running from the lift station and had spewed oil and waste into the environment. The discharge from the wash bay flows into the lift station. The control system was rewired to bypass controls system alarm. On a previous inspection by Patrick Reed, the wash bay oil water separator had no down pipes in either the primary or secondary chambers. At this inspection, MHC Kenworth had a plumber put down pipes in the oil water separator. However, adjustments need to be made to these per TWU. Also, while inspecting the wash bay, additional violations were observed and those violation were pointed out. Secondary containment is needed on their used oil tank as well as the temporary tank where they drain used oil from oil filters, etc., which gets pumped to the used oil tank outside of the wash bay.

The site manager called Hazmat to get a quote for cleanup of the spill into the environment. Hazmat showed up while we were still on site.

TWU gave MHC Kenworth a deadline to complete environmental cleanup before rain appears in the weather forecast.

Property Account Report

BOWIE CENTRAL APPRAISAL DISTRICT
Date Updated: Saturday, October 01, 2016

Appraisal Year: 2016
Account Number: 15660002709 (35209-1/176024)

Owner Info

Account Info

Owner Name	H M TEXAS REAL EST LP	Deed Date	
Mailing Address	% MURPHY-HOFFMAN CO 1524 N CORRINGTON KANSAS CITY, MO 64120	Owner Percentage	100.0%
Situs Address	912 EASTLOOP DR TEXARKANA	Exemptions	
Legal Description	M E P & P RWY CO A-435 3666/164 03/15/02 BLK/TRACT 20D 10 ACRES	Last Date To Protest	5/12/2016

Property Value Information

Land	330,000
Improvements	1,173,313
Personal	
Mineral	
Market Value	1,503,313
Ag Market	
Ag Productivity	
Timber Market	
Timber Productivity	
Productivity Loss	
Homesite Cap Loss	
Appraised Value	1,503,313

Current Year Jurisdiction Values

Code	Jurisdiction Name	Appraised	Exemptions	Taxable
	BOWIE APPRAISAL DIS	1,503,313		1,503,313
	TEXARKANA COLLEGE	1,503,313		1,503,313
	LIBERTY EYLAU ISD	1,503,313		1,503,313
	TEXARKANA CITY	1,503,313		1,503,313
	BOWIE COUNTY	1,503,313		1,503,313













CITY OF
TEXARKANA
Public Works Department TEXAS

919 Elm Street
Texarkana, TX 75501
Phone (903) 798-3948
Fax (903) 792-6419

Stormwater Permit Application – Special Construction Site

Project Information:

Name/Addition/Lot No.: Sunil Pokhrel 6007 Last Creek

Description: _____

Physical Site Address: 6007 Last Creek

Amount of Land Disturbed (Acres): _____ Part of a Common Plan of Development Yes No
Total Project Area (Acres): _____ Is this an addendum to an existing SWP3? Yes No

Owner/Developer Information:

Name: Sunil Pokhrel

Address: P.O. Box 1154 TEXARKANA TX 75501

Phone: (903) 794 8544 Fax: () _____ Work E-mail: _____

Consultant/Engineer Information:

Name: PAUL STEWART

Address: 497 Willsmith Rd TEXARKANA TX 75501

Phone: (903) 277 5582 Fax: () _____ Work E-mail: PAULSTEWART301@YAHOO.COM

Stormwater Permit Application is to be posted at the construction site.

I certify that the information on this form and the attached plans is true and accurate to the best of my/our knowledge and will abide by the conditions of the City of Texarkana, Texas Stormwater Management Ordinance.

PAUL STEWART
Applicant's Printed Name

Paul Stewart
Applicant's Signature

10-27-16
Date

For Office Use Only	
<input type="checkbox"/>	Erosion and Sediment Control Plan (ESCP)
Notes:	

Signature Approval by Stormwater Engineer

Date Approved

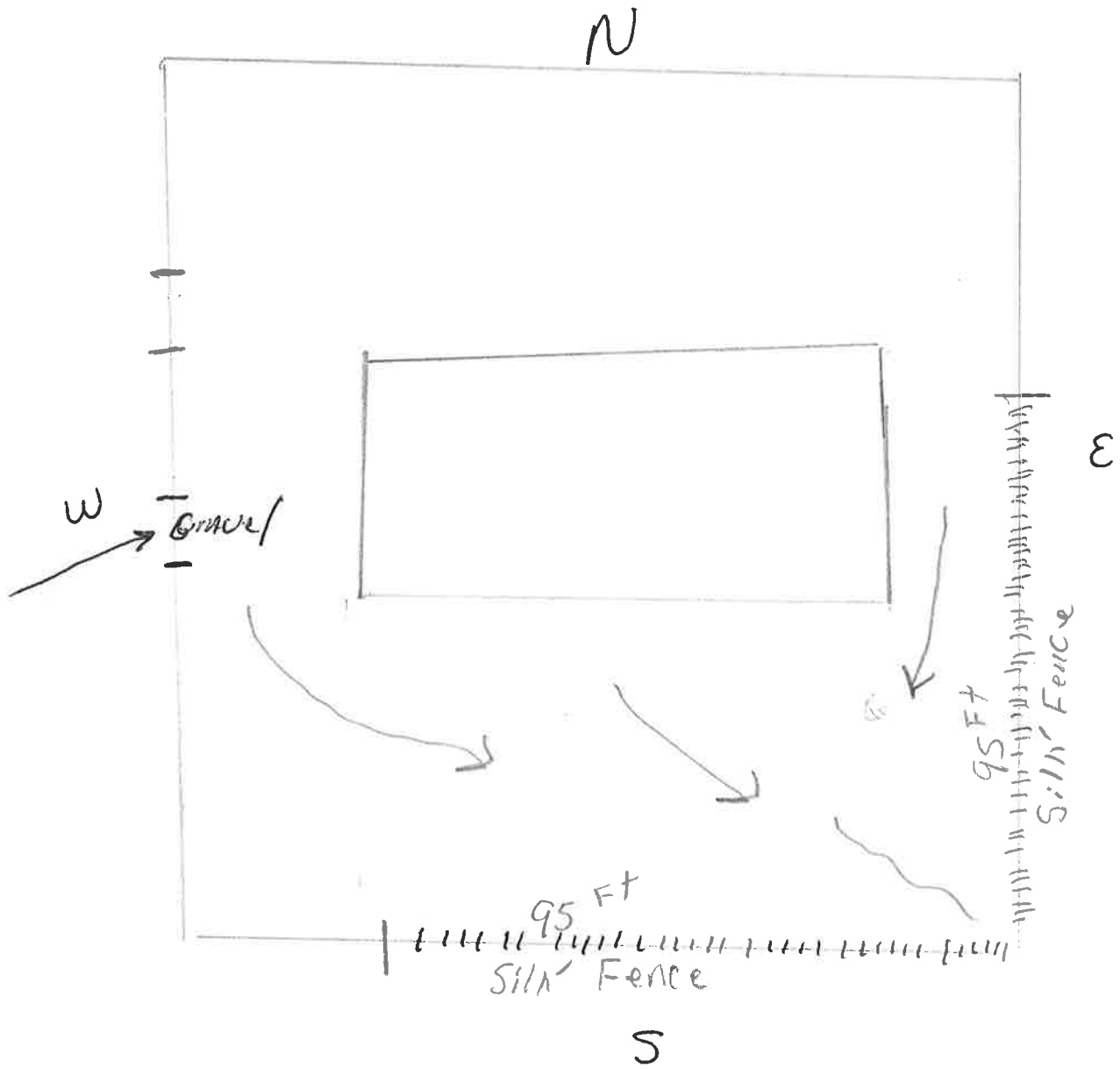

Silk Fence will control the Drainage into Ditch











TEX-Puckett, Laura

From: TEX-Henslee, Dustin
Sent: Monday, February 01, 2016 10:40 AM
To: TEX-Eitel, Jeff; TEX-Smith, Danny; TEX-Ritchie, Robert; TEX-Daniel, Mashell
Cc: TEX-Puckett, Laura; TEX-Dooley, Kyle
Subject: Wash Bay at Fleet

All,

The wash bay at fleet is now ready for everyone's use. Fleet has purchased the first round of supplies for everyone, and they have also installed a locker with each departments name on it for you to keep your supplies in. Jeff H. and Angela H. have these supplies in their office so you will need to pick them up from them. If you want to lock your supplies up then you will need to furnish your own lock. Each department will be responsible to purchase their own supplies after you run out of the supplies fleet has purchased.

ALL city vehicles shall be washed in this bay. There will be a few exceptions, but you will need to get it approved through our office first.

If you have any questions then please let me know.

Dusty Henslee, P.E., CFM, CSI

City Engineer

Public Works Department

City of Texarkana, Texas

Office: (903)-798-3948

Cell: (903)-908-1808

Fax: (903)-792-6419

Email: dustin.henslee@txkusa.org

Email communications through this office may be subject to Texas Public Records laws and may be shared with others.

ANSWER KEY

PAGE 2

- A. circle the city
- B. circle any area on the coast
- C. circle a steep area on the mountain with houses

PAGE 4

- | | |
|-----------------------|----------------------|
| #1 | #2 |
| Month of Highest Flow | Month of Lowest Flow |
| 1. Mississippi: April | September |
| 2. Mekong: September | January |
| 3. Rhine: January | October |
| 4. Amazon: June | November |
| 5. Congo: December | August |

#3 Amazon

#4 240,000 cubic meters X 1,000 liters =
240,000,000 liters of water (Amazon)

PAGE 5

- A. Mississippi River Basin
- B. Amazon River Basin
- C. Mekong River Basin
- D. Congo River Basin
- E. Rhine River Basin

PAGE 7

Number of Buildings Flooded
10-year = 13
100-year = 29
500-year = 50

PAGE 11

Strategy	Action
Monitoring System	Measuring stick for water level
Oral Tradition	Storyteller/elder
Migration	Canoe with rowers
Human-made barrier	Levee (wall lining river bank)
Human-made barrier	Dam
Secure Home	House on stilts
Flood hazard map	Person viewing map
Early warning system	Tower with siren
Water mark	Measuring stick with flood notice
Preserving wetlands	Wetland with ducks and cattails

PAGE 15

Syllable Search Answers:	If readers answer each question correctly, they will spell: <i>Flood Ready Now!</i>
Communication, Listening	
Compromise, Negotiation	
Teamwork, Cooperation, Respect	

DISCOVER FLOODS BROUGHT TO YOU BY :



The World Meteorological Organization (WMO) is a specialized agency of the United Nations. It is the UN system's authoritative voice on the state and behavior of the Earth's atmosphere, its interaction with the oceans, the climate it produces and the resulting distribution of water resources. The vision of (WMO) is to provide world leadership in expertise and international cooperation in weather, climate, hydrology and water resources and related environmental issues and thereby contribute to the safety and well-being of people throughout the world and to the economic benefit of all nations. www.wmo.int



The Associated Programme on Flood Management (APFM) is a joint initiative of the World Meteorological Organization (WMO) and the Global Water Partnership (GWP). The mission of the APFM is to support countries in the integrated management of floods within the overall framework of integrated water resources management. The programme has been financially supported by the Governments of Japan and Switzerland. www.apfm.info



The mission of Project WET is to reach children, parents, educators and communities of the world with water education. Project WET's Kids in Discovery series (KIDs) is designed to help kids discover the scientific, natural, cultural and historical wonders of their world. www.projectwet.org



Funding for this activity and publication was made possible through support provided by the Office of U.S. Foreign Disaster Assistance, Bureau for Democracy, Conflict and Humanitarian Assistance, U.S. Agency for International Development (USAID OFDA) through an inter-agency agreement. The opinions expressed herein are those of the author(s) and do not necessarily reflect the views of the U.S. Agency for International Development.



This publication was prepared by the Project WET Foundation under a Subcontract with the University Corporation for Atmospheric Research (UCAR) under Cooperative Agreement No. NA06OAR4310119 with the National Oceanic and Atmospheric Administration (NOAA), U.S. Department of Commerce (DoC). The statements, findings, conclusions, and recommendations are those of the author(s) and do not necessarily reflect the views of NOAA, DoC or UCAR.

Project Management Team: Sandra DeYonge, Project leader/Co-author, PWET; Dennis Nelson, Co-project leader/science methods contributor, PWET; Joachim Saalmüller, Co-project leader/expert reviewer, WMO; Kristen Read, Co-manager, PWET; Stephanie Kaleva, Co-manager, PWET; Scott Bean, Co-author; Tom Cech, expert reviewer; Designed by Thomas Adkins, SAB

World Meteorological Organization Expert Reviewers: Avinash C. Tyagi, Director, Climate and Water Department; Masahiko Murase, Professional Officer; Joachim Saalmüller, Project Officer; Momadou M. Saho, Chief, Education and Fellowships Division; Sophia Sandström, Intern; Daisuke Yamashita, Project Officer

UCAR, Kelly Sponberg, Joss Project Specialist

Published by Project WET International Foundation, Copyright 2009, Dennis L Nelson, CEO and President
Printed February 2009

OTHER KIDS BOOKS YOU WILL ENJOY

Select titles available in Spanish

Please visit our website at www.projectwet.org to view all of our KIDs books.



Mixed Sources
Product groups from well-managed forests, controlled sources and recycled wood or fiber
www.fsc.org Cert. No. SES-COC-001458
© 1996 Forest Stewardship Council



TO PURCHASE COPIES

contact: Project WET
1001 West Oak Street,
Suite 210 Bozeman MT 59715
406.585.2236 or
toll-free 866.337.5486
info@projectwet.org
www.projectwet.org

ISBN 978-1-888631-61-6



Discover FLOODS

illustrations by Peter Grosshauser

WHAT IS A FLOOD?

FLOODS AROUND THE WORLD

HIGH WATER HISTORY

THE NATURE OF FLOODING

MANAGING FLOODS

ACTION PACK

WHEN FLOODS STRIKE

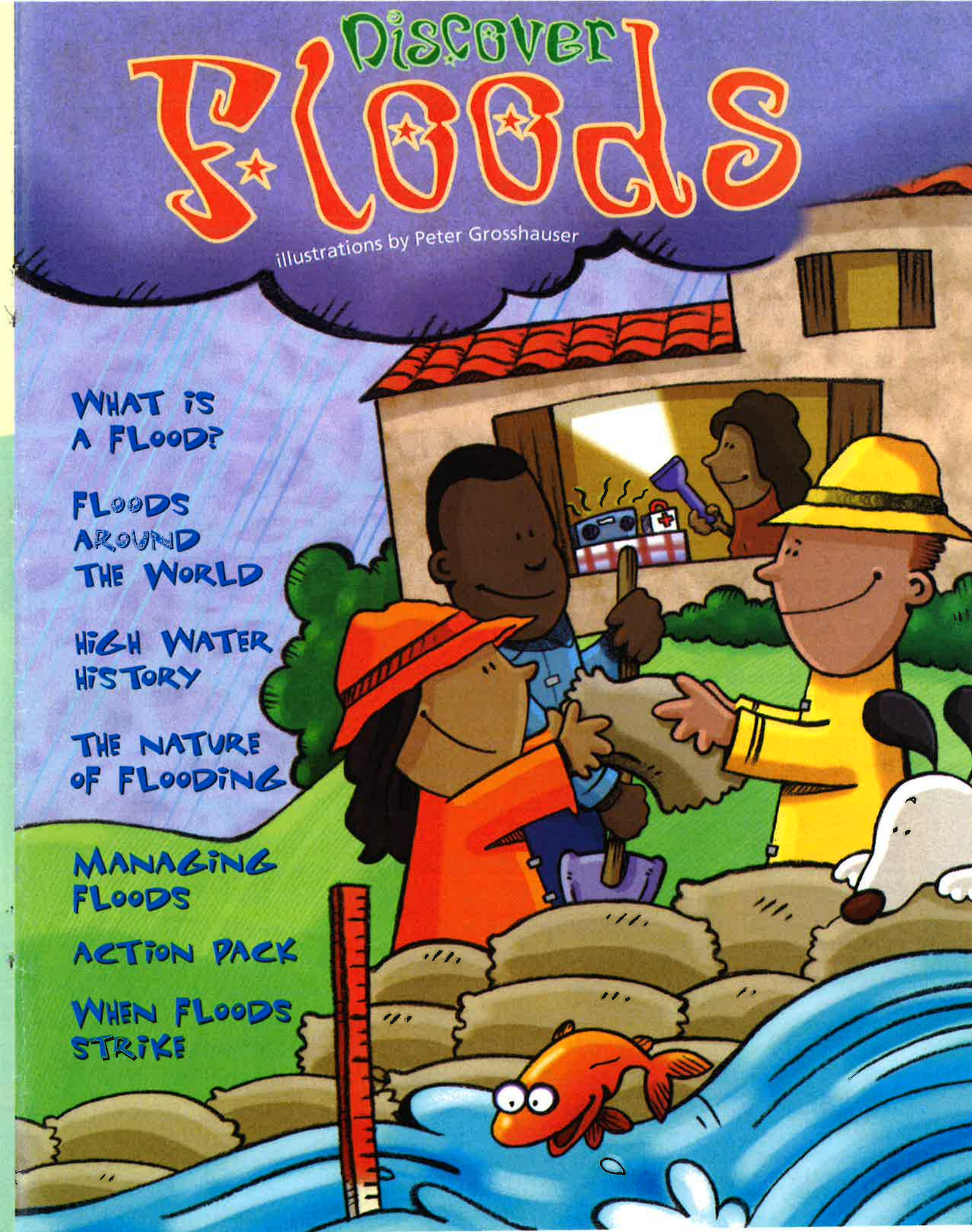

WORKING TOGETHER

When severe flooding happens, help comes flooding in, too, from many sources. It takes a lot of people with different skills working together to manage the situation and to help lessen the dangers.

Scientists forecast the severity of flooding in order to warn people. Local, state and federal government **agencies** in addition to **elected leaders** work together to coordinate emergency efforts.

Engineers look for ways to repair damage done to levees and dams.

Media outlets such as television and radio stations broadcast public service announcements about ways to stay safe.

Emergency response personnel respond to life-threatening situations.

Disaster relief workers bring safe drinking water and food to flood victims.

Utility company crews work to restore power, gas and water.

Citizens clean their homes to prevent mold.

Military personnel support government agencies and assist relief organizations.

Medical professionals tend to the injured and inoculate people against disease.

Contractors repair or rebuild buildings and roads destroyed by flooding.

ACTIVITY

Moving as One

Work together the way people during a flood must do. Gather eight friends. Each one can represent a different profession (scientist, newscaster, government employee, etc.).

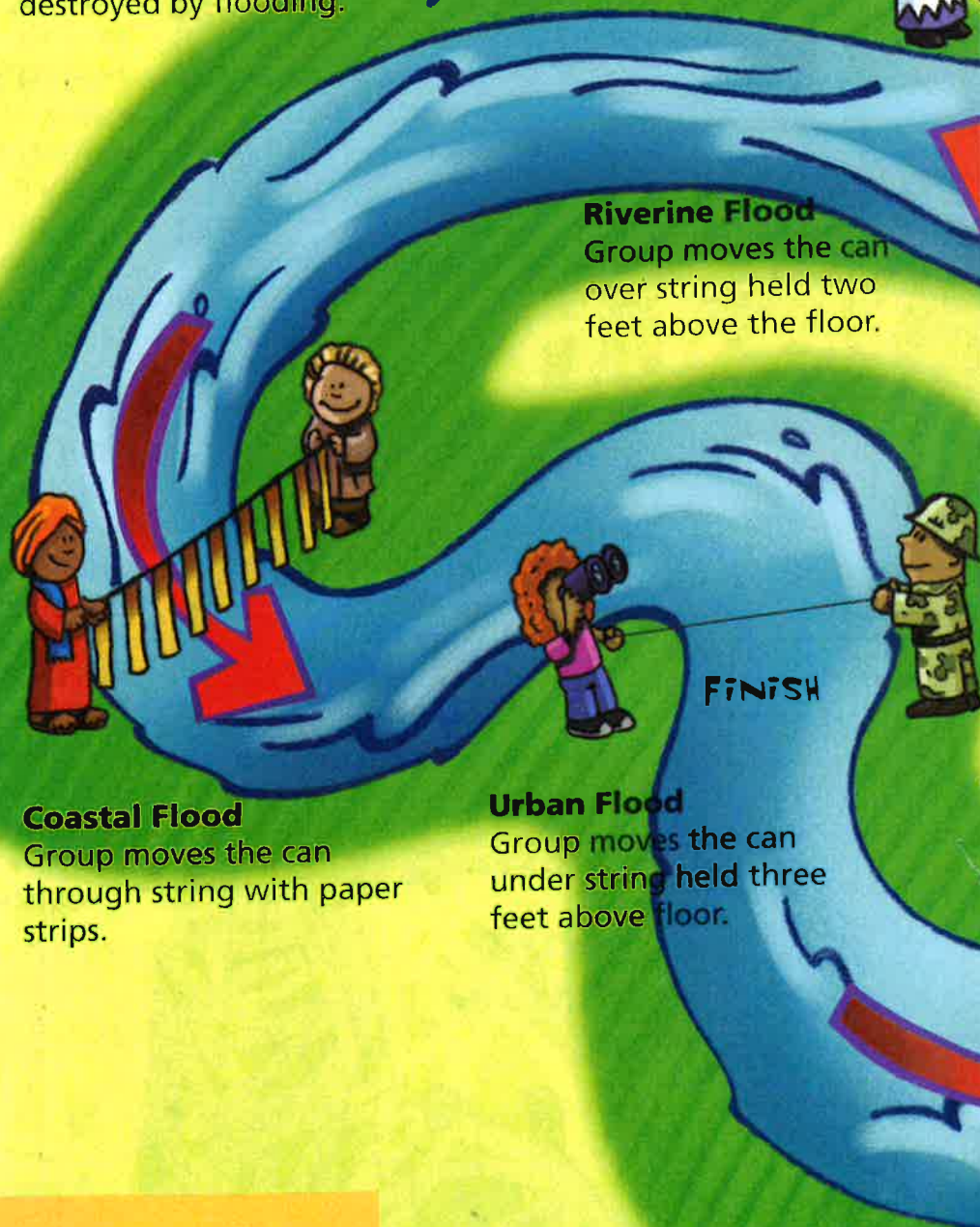

Riverine Flood

Group moves the can over string held two feet above the floor.

Coastal Flood

Group moves the can through string with paper strips.

Urban Flood

Group moves the can under string held three feet above floor.

A FLOOD?

to **wetlands** (land that is often flooded), which is needed for many species of animals and plants to live.

Types of Floods

Riverine floods

When rivers or streams overflow their banks, these

are called **riverine floods**.

They can be caused by heavy and prolonged rains or when **snowmelt** (water from melting snow) happens too quickly in the springtime. They generally last for several days to weeks.

Flash floods

During a **flash flood**, water rapidly rises, then falls within a few hours. In many cases, water quickly rushes down slopes, which can be dangerous.

Urban floods

Flooding can happen in cities, also called urban areas, where pavement and rooftops prevent rainfall from soaking into the ground. Storm drains are made to carry the storm water away, but they can't always keep up.

Coastal floods

When ocean water rises above a normal high tide and floods occur on the coast, it is called a **coastal flood**. Sometimes wind storms, such as typhoons and hurricanes, push a large volume of water toward the coast, which is called a **storm surge**.

Watch Out Below!

Flooding in hilly or mountainous areas can cause **landslides** (masses of rock and water-soaked earth that break free and slide downhill) and **mudflows** (similar to landslides but made of thick mud and debris). The roots of grass, shrubs and trees on mountain slopes can help hold the soil together and soak up some of the water to prevent these from happening.

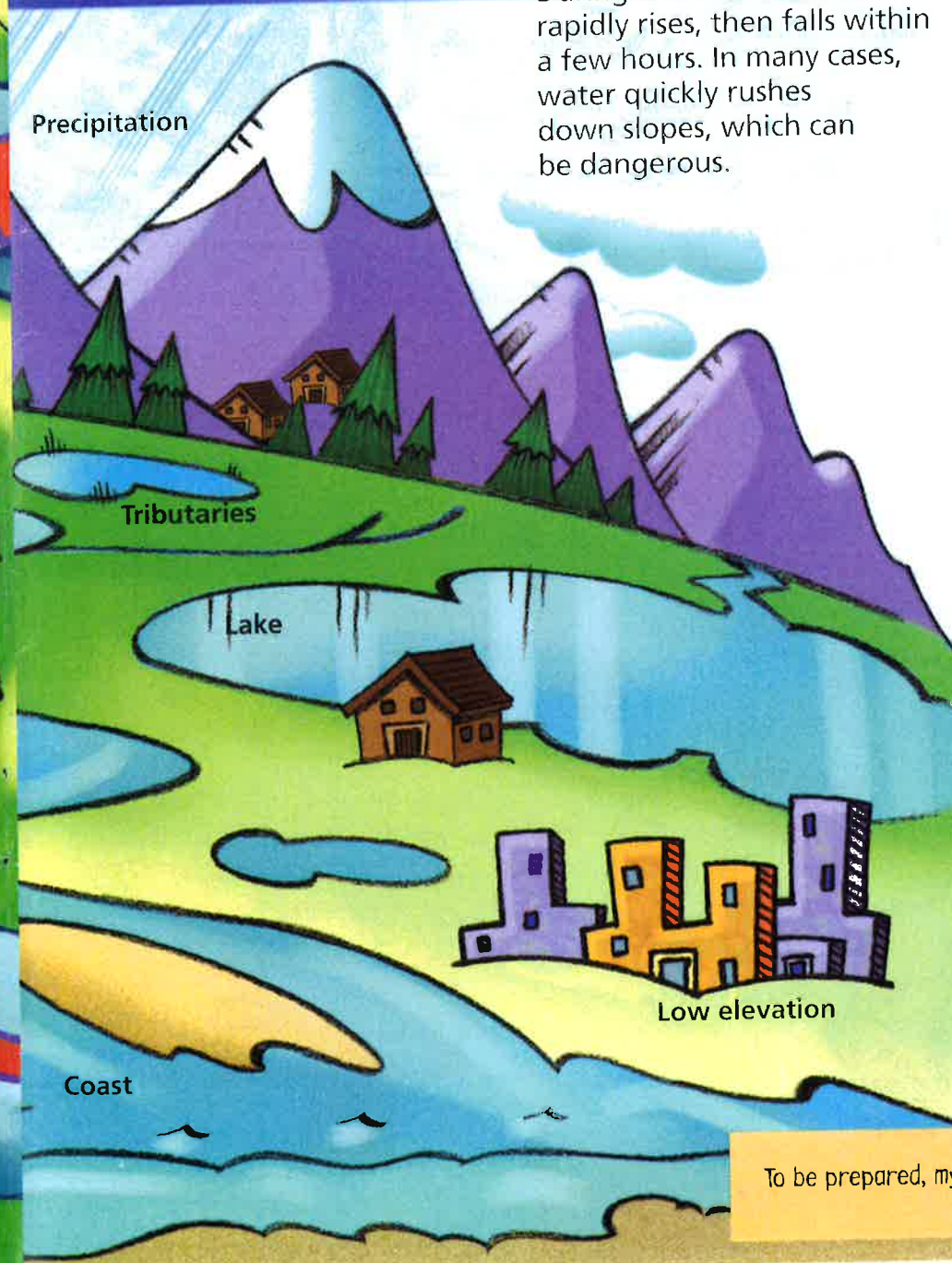

To be prepared, my family should have an emergency plan.
a. T (L) b. F (T)



In a 100-year floodplain, floods happen only once every 100 years.
a. T (M) b. F (W)

ACTION AND THE WORLD

Action Pack

Flooding is a natural part of our world and one that we continue to learn to live with. Our ability to predict floods is improving as we increase our knowledge about their causes. And new technology is giving us better systems to warn people about possible flooding.

Still, flash floods can happen so quickly that sometimes people can't be warned in time. That's why it is important to be aware of the risk of flooding wherever you are, and to be prepared.

WHAT YOU CAN DO

- ✓ Prepare a supply kit.
- ✓ Put special treasures and memorabilia in a waterproof container.
- ✓ Have a family disaster plan. Know where to go and where your family will meet.
- ✓ Know the safest route to higher ground.
- ✓ Have your pets and your personal items ready, so if you are told to evacuate, you can go immediately.
- ✓ Listen to warnings on the radio and TV. Follow instructions.
- ✓ Make those around you aware of a possible flood event.
- ✓ If you are on vacation, be aware of your surroundings.
- ✓ Pay attention to the weather and think about what it might mean for you and your activities.
- ✓ Stay away from rushing water, storm drains and rising rivers.
- ✓ Stay out of flood water. Never drive through flood water in a vehicle.
- ✓ Understand weather patterns in your area.



Wetlands are like sponges and can soak up extra water.
a. T (N) b. F (S)



Rhine River Basin, Europe

Starting in the Alpine Mountains of Switzerland, the Rhine River winds its way through Germany, France and the Netherlands (Holland) to the North Sea. Although there are **dikes** (long banks built alongside rivers), flooding remains a challenge for all the countries that share the river basin.

and empties into the Gulf of Mexico. Many things came together to produce the Great Flood of 1993: saturated soils from the previous year's rainfall, high snowmelt and spring rains, several summer storms and heavy rainfall, in addition to many failed levees.

amazing five to eight feet (1.5 to 2.5 meters) of rain fall each year in the Congo Basin. Flooding enriches the floodplain and tropical forests; nutrients from the flooded forests move into the aquatic food chain and nourish the Congo Basin's diverse fish.



The Mekong River Basin, Asia

Flooding occurs in this basin so regularly that the people have adapted by sometimes moving to higher ground during the flood season. Though damage can be costly in cities, floods provide water for crops and leave behind **sediment** (tiny pieces of rock and other material carried by water) that makes the soil fertile for raising crops.

The Amazon River Basin, South America

Originating high in the Andes Mountains and flowing into the Atlantic Ocean, it contains 20% of the world's fresh water. Each year during the rainy season, the Amazon River rises over 30 feet (nine meters) and inundates bordering forests, which enriches the soil and allows freshwater fish to feed on fruits fallen from the trees.

The Mississippi River Basin, North America

The Mississippi River starts as a small brook in northwestern Minnesota in the United States

The Congo River Basin, Africa

Critical to transportation, the Congo River has been named Central Africa's "highway." An

ACTIVITY

Draw a line from the name of the river basin to its location on the map.



If I hear official warnings about flooding, I should take them seriously.
a. T (O) b. F (L)

MANAGING HISTORY

Flood Management

People often choose to live in a floodplain because of the many advantages (e.g., fertile soil for farming, water for irrigating crops, transportation of goods on the river). To protect themselves and their property, there are many things that people can do to be safer living in flood-prone areas.

Monitoring Systems and Evacuation

Using technology, scientists can monitor rainfall amounts and water levels upstream to predict when and where floods may occur, so that people can be prepared. They can warn people to **evacuate** (temporarily move away from an area).

Oral Tradition

In areas of 100- or 500-year floods, community members may never have experienced one. Through **oral tradition** (telling stories which often become lessons passed down from generation to generation) people can be warned about flood-prone areas.



Rivers around the world flood at the same time of year.
a. T (S) b. F (D)

Migration

Every year, the people of Barotse land in Western Zambia travel from the Barotse floodplain to higher ground. After the floods recede, the people move back to take advantage of the rich soil deposits.

Human-made Barriers

A **levee** is a human-made barrier built to prevent a river from overflowing its banks or ocean water from inundating a coast.

Dams are barriers that hold water and control the amount of water that travels downstream. They can serve many purposes, including flood control, water storage for towns and cities, crop irrigation and power generation.

Secure Homes

Some people prevent flood damage to their homes by raising them on stilts so that flood waters pass beneath them or building on an elevated area.

Flood Hazard Map

This map indicates flood-prone areas within a community or region.

Flood Insurance Programs

After a flood, insurance can help people, who have paid for policies, recover losses.

Early Warning Systems

Many communities have early warning systems. These may include: a siren, home telephone notification, local radio station messages, police broadcasting warnings via megaphone, visits by volunteer fire brigade.

Water Mark

To help a community recognize flood risk, standard signs or flooding marks remind residents of the water level of past floods.

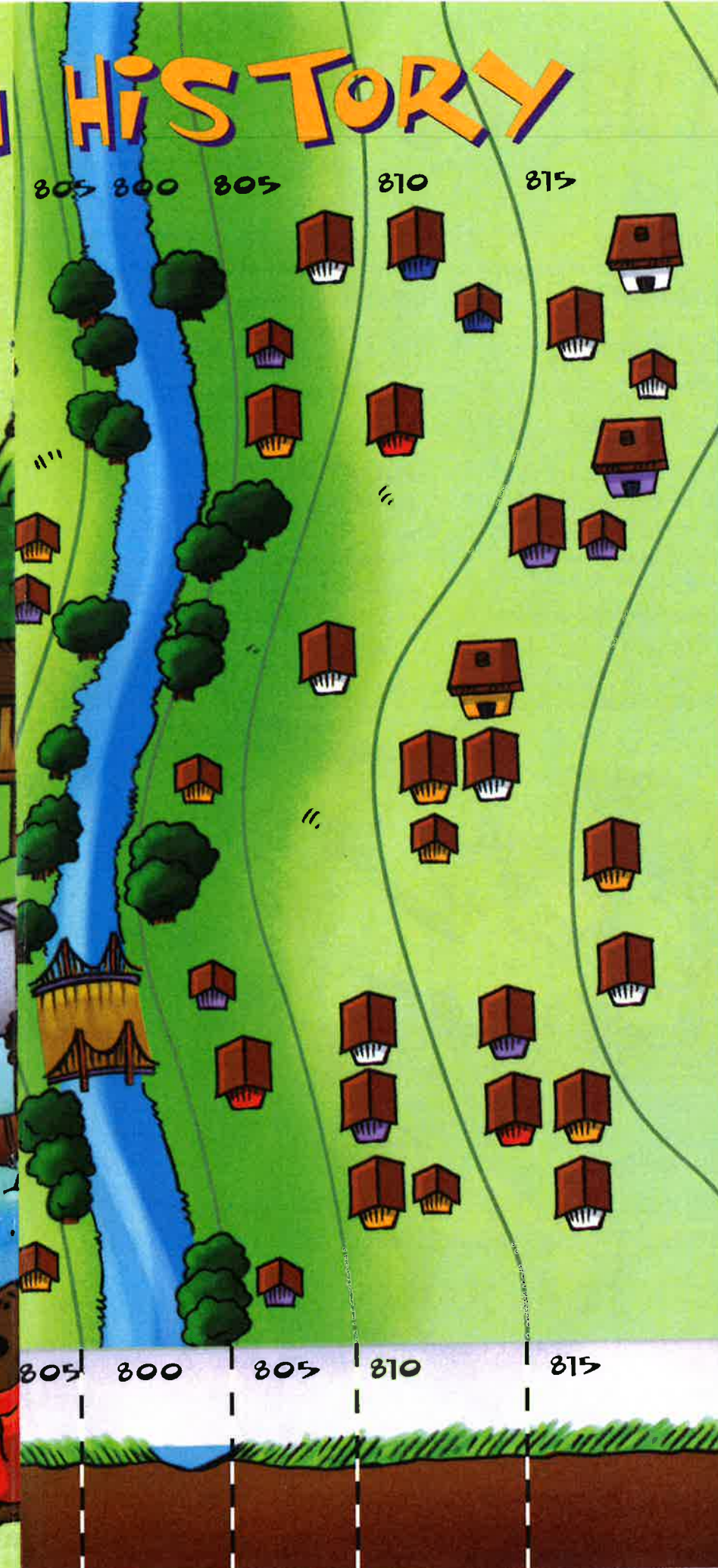

DATA FOR A HYPOTHETICAL RIVER

Average winter flow 800 ft msl (mean sea level) (non-flood level)

Bank full	805 ft msl
Minor flooding (water slightly over river banks)	806 ft msl
10-year flood	810 ft msl
100-year flood	815 ft msl
500-year flood	820 ft msl

One way to determine the **extent** (area flooded) of a 10-, 100-, or 500-year flood is to locate the elevation shown on maps as contour lines, located on both sides of the river. Let's say we want to determine how many buildings will be flooded at the hypothetical site during a 10-year flood. First find the contour lines of a 10-year flood (810 feet msl) on both sides of the river. Carefully shade in all the land between those two lines in red.

Everything shaded is impacted by flood waters. Use different colors to shade flooded areas during 100- and 500-year floods. Record the number of buildings flooded.

	Number of Buildings
10-Year	_____
100-Year	_____
500-Year	_____



A flood is always a bad thing.
a. T (O) b. F (R)

THE NATURE OF FLOODING

When floods happen in nature, land, trees and other plants help absorb extra water like a sponge. When the land is **saturated** (too full to absorb any more water), the water becomes runoff that flows to the lowest point. Wetlands (land covered with shallow water) act like nature's **reservoirs** (storage areas for water). They retain water from the wet season for use during dry times.

When land is covered with asphalt and concrete, water is prevented from being absorbed into the soil. Storm drains may carry water away from urban areas, but all this extra water can sometimes add to problems downstream.

When flood waters recede, mud, **debris** (rubble or wreckage), polluted water and damaged homes are often left behind. Diseases can spread. Crops may be destroyed, leading to food shortages. However, most **farmland** (land on which crops are grown) in the

long-term is enriched from the added nutrients that floods deposit.

See the Difference

The effects of a flood in a natural setting are different from an urban one. Some forests in the Amazon basin are flooded twice a year with 20 to 23 feet (6-7 m) of water! Big fish, pacu, swim in and feed on fruit that falls from the trees. Manatees graze in submerged grasses. Caiman wait under tropical trees for

an opossum to slip and fall while red howler monkeys play in the canopy. The flood waters add nutrients to the forest and the forest provides nutrients to the river.

Flood Indicators

Hydrologists (people who study water) watch **indicators** (clues) that may predict floods and drought.

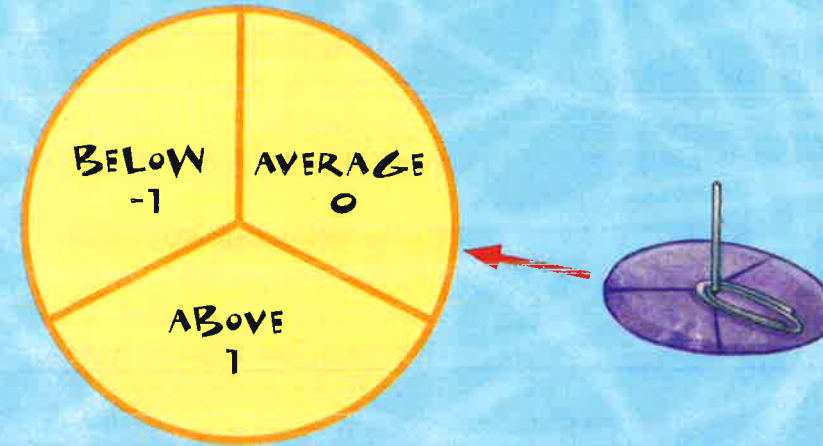

FALL	WINTER	SPRING	SPRING	SPRING
above avg. fall precip. 1	above avg. snow pack 1	late spring snow melt 1	high spring temperature 1	above avg. spring precip. 1
average fall precip. 0	average snow pack 0	avg. spring snow melt 0	avg. spring temperature 0	average spring precip. 0
below avg. fall precip. -1	below avg. snow pack -1	early spring snow melt -1	below avg. spring temp. -1	below avg. spring precip. -1

Player

1 _____

2 _____

ACTIVITY

The Indicator Game

Rivers have different indicators. The Red River of the North watershed is shared between Canada and the United States. Discover indicators of high and low water flows in the Red River. First, make a spinner by straightening part of a paperclip and pushing it through the center of the circle from behind. Place another paperclip over that "post" and use it as the arrow. Record your number and season for each turn. Each player takes turns spinning and moves through fall, winter and spring. Based on your indicators, will it be a high, low or average water year on the Red River?

One of the most destructive Red River floods in the last 100 years happened in 1997. All the indicators were right for a big flood. Imagine landing on the number one box from fall through spring—five high water indicators in a row!

Flood Indicators, the Ganges River

The Ganges River, Ganga in most Indian languages, begins in a number of glaciers high in the Himalayas. After it leaves the highlands, most of its 1,560 mile (2,510 kilometers) journey is across the broad plain of India where it is joined by several large tributaries from Nepal until it empties into the Bay of Bengal south of Bangladesh.

The Ganges floods every year; these events are usually considered beneficial unless they are unusually long-lasting or widespread. Flood indicators include both heavy monsoon rains (June-September) in the Himalayan foothills and the plains that generate high river discharges and high tides.

When rivers flow through many countries, it is important that people upstream warn downstream dwellers of high rainfall and swollen rivers — indicators that a flood may be coming. Weather and water experts need to work together to prepare a flood forecast that is shared with downstream forecasting centers, water management institutions and emergency services. Forecasts can be quickly communicated through satellite-based systems to authorities who alert people at risk to move families, belongings and livestock to higher, safer ground.



It's important to know what your water address is, so you can be prepared for water emergencies.
a. T (E) b. F (A)



Rushing water is stronger than I am.
a. T (A) b. F (E)

HIGH WATER & FLOODS

The reasons to live in an area with a history of flooding can often outweigh the risks. Rivers are a source of water for drinking, irrigation, fishing, power generation and recreation. **Waterways** (bodies of water that boats can use) make it easy for shipping goods to market and travel. Also, floodplains usually have rich soil, which is good for growing crops.

What's a 100-Year Flood? By its name you might think that a 100-year flood is one that happens once every 100 years. Actually, it means that historic measurements show that the likelihood that a river will reach a certain flood level, in any given year, is just 1% (or 1 in 100).

Floods are labeled as 10-year, 100-year or 500-year floods. Think of these as big, bigger and biggest. The lower the number, the more likely it is that a flood of that size will happen. Flood hazard maps show how far flood waters spread during these floods and serve as a guide to where houses and roads

should be located. Each flood is measured in feet or meters above **msl** (mean sea level). Sea level is zero msl.

ACTIVITY

One in Ten

Number spaces on a lined sheet of paper from one through 10, representing 10 years. Cut another sheet of paper into 10 pieces. Write the word "flood" on just one of them. Put the pieces in a container, mix them up and draw one out. Record whether you drew a "blank" or "flood" on the line for the first year. Return the paper back into the container and draw again. Repeat and record your results until you've completed all 10 years. You may have no floods for 10 years. Or you may have floods every year. Either way, your chance of a "flood" is exactly the same, every time: one in 10!

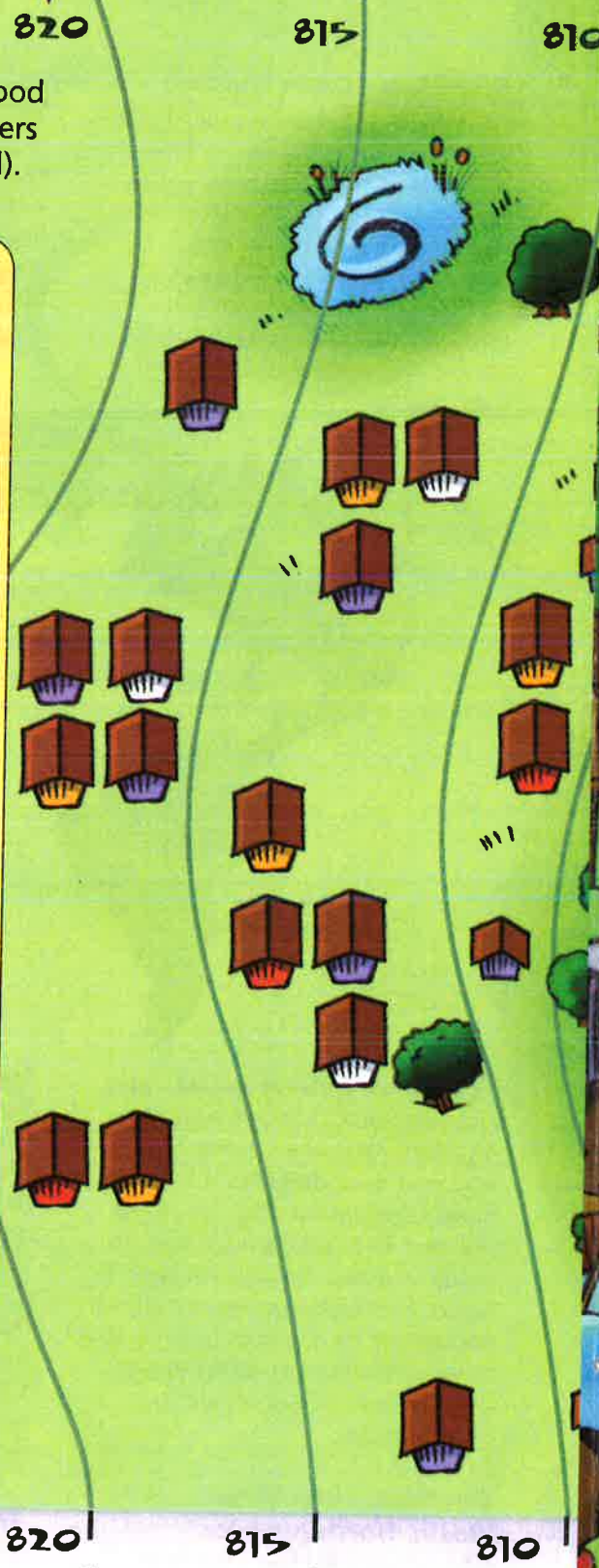

Preserving Wetlands

Because wetlands such as marshes and swamps can act like nature's sponges during times of flooding, they're a natural way to reduce flooding.

Reduce Risk

Match a strategy for reducing risk in flood-prone areas with a picture. You should have a total of 10 matches. Check answers in the key.

What is your water address?

Think about where you live. Answer the questions below and discuss them with your teacher or parents. If your water address indicates flood risk, be sure you are prepared. Turn the page to learn about flood preparedness.

- How far are you from a river, lake or ocean?
- Has it ever flooded where you live?
- Have there been changes to the topography where you live that might affect where water goes?
- How does weather affect you where you live?
- Do you experience monsoons or spring thaws?
- What seasonal changes affect the water around you?



Little streams and rivers can become deep and dangerous quickly in a flash flood.
a. T (D) b. F (S)



Streamflow is measured in volume per unit of time.
a. T (Y) b. F (B)

FLOODS AROUND PACK

What's a Hydrograph?

The amount of water in a river changes seasonally and year to year. Water managers measure the river's **streamflow** (amount of water passing through) at **gaging stations** (measuring stations) and make **hydrographs** (charts). A hydrograph records the streamflow at one spot over a period of time in cubic feet per second (**cfs**) or cubic meters per second (**cms**).

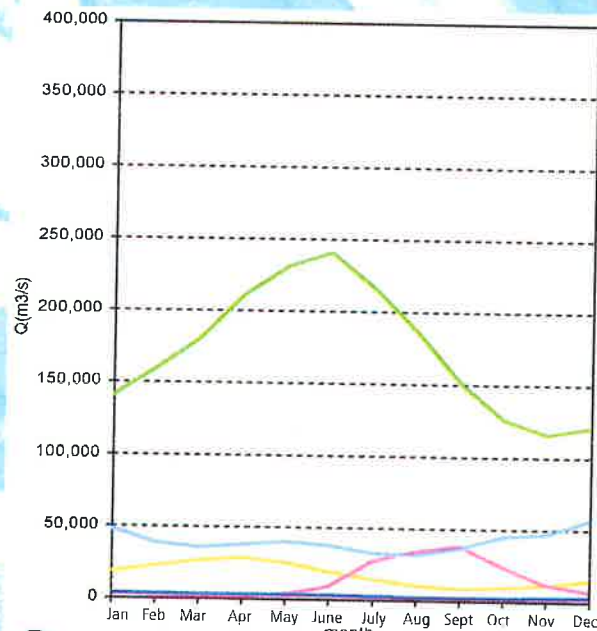

- Mississippi at Vicksburg (1931-1999)
- Mekong at Phnom Penh (1960-1973)
- Rhine at Lobith (1901-2006)
- Amazon at Obidos (1968-1996)
- Congo at Kinshasa (1903-1983)

*Data is gathered at gaging stations along a river as stream height and calculated as (cfs) in the United States and (cms) in the rest of the world. This graph represents the average flow for each month for the life of the gaging station (the years in parenthesis). Rainfall and stream gaging stations help water managers forecast floods.

+ Focusing on the Rhine River

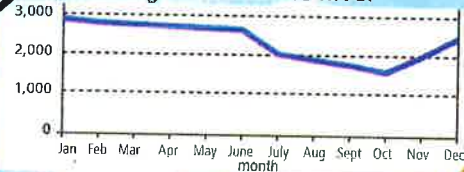

How many gallons would fit into a cubic foot, or liters in a cubic meter?

It takes about seven and one-half gallon jugs (7.48 to be exact) to fill a cubic foot. It would take 1,000 liters of water to fill a cubic meter.

What Size is Your Cube?

How big is a cubic foot or cubic meter? See for yourself. Draw one-foot by one-foot or one-meter by one-meter square in the middle of a large piece of cardboard. Then, on each of the four sides, draw the same size squares. Now, carefully cut out the five squares in the shape of a cross. Fold the ends up and tape them together. There's your cubic foot or meter.

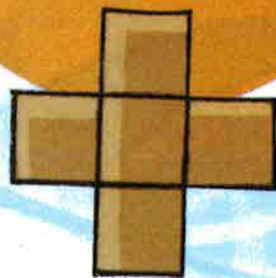
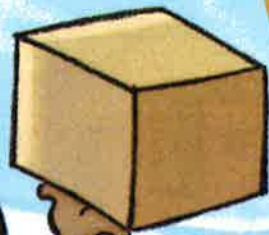

Look at the hydrograph and answer the following questions.

1. In which month does each river have the highest flow?
2. For each river, what month has the lowest flow?
3. Name the river that shows the largest difference between high and low flow.
4. At its highest point how many liters of water are flowing in the river with the highest flow?

See the Answer Key. That's a lot of water!



Two feet of moving water is enough to float a car or truck and take it away.
a. T (O) b. F (F)

PACK YOUR SUPPLY KIT

- Circle what you might need just in case a flood happens to you.
- Jugs/bottles of water**
drinking water may be polluted
 - Flashlight**
power may be out
 - Battery-powered or hand-crank radio**
to hear warnings and updates
 - Batteries**
to power the radio and flashlight
 - First aid kit**
for minor scratches/injuries
 - Rain gear**
to keep you dry in a storm
 - Canned food**
fresh food may be contaminated by flood waters
 - Can opener**
to open canned food
 - Emergency cooking supplies**
sources of power with which to cook may be unavailable
 - Pet food, water**
they need basic essentials, too
 - Medicine**
anything you need to stay healthy
 - Emergency phone numbers**
you may need to call for help if you are separated from your family



You should always include a can opener in your emergency supply kit.
a. T (O) b. F (A)

WHAT IS

Floods have always been part of nature and our world. They can happen just about anywhere there is too much water in one place, at one time. The opposite of a flood is **drought**—a period of water shortage when lack of precipitation produces dry conditions lasting as long as several years.

During a **flood**, water in a stream **crests** (reaches its highest peak), usually for a short time, and then **recedes** (goes down) at a slower rate. In the United States, the term flooding is also used whenever water rises above its normal boundaries and spills onto normally dry land. Most other countries have a separate word for this type of flooding, called **inundation**.

Floods can be destructive, but they can also do a lot of good. They can leave behind important nutrients in **floodplains** (flat areas of normally dry land that are alongside many rivers, streams and lakes) that make them ideal for growing crops. They also bring water

Where in the Watershed?
Study the photos below for clues where these flooding events occurred in the **watershed** (all of the land area draining into a particular river or body of water). Circle the area and check your answers in the Key.

High elevation

Headwaters

Creek

Streams

River

Valley

Wetlands

Floodplain

Estuary

Mouth

Ocean

In each corner box, see a question that you will be able to answer once you complete this booklet. Based on whether you select true (T) or false (F), pick the letter associated with it. If you answer each question correctly, a life-saving message will emerge.



When I see a flooded street, I should stay away from it.
a. T (pick letter F) b. F (pick letter Q)



WHEN FLOODS STRIKE

Now, tie eight strings evenly around a rubber band that snugly encircles a can $\frac{3}{4}$ -full of water. Try to lift the can together and move it around the challenges, representing different kinds of floods.

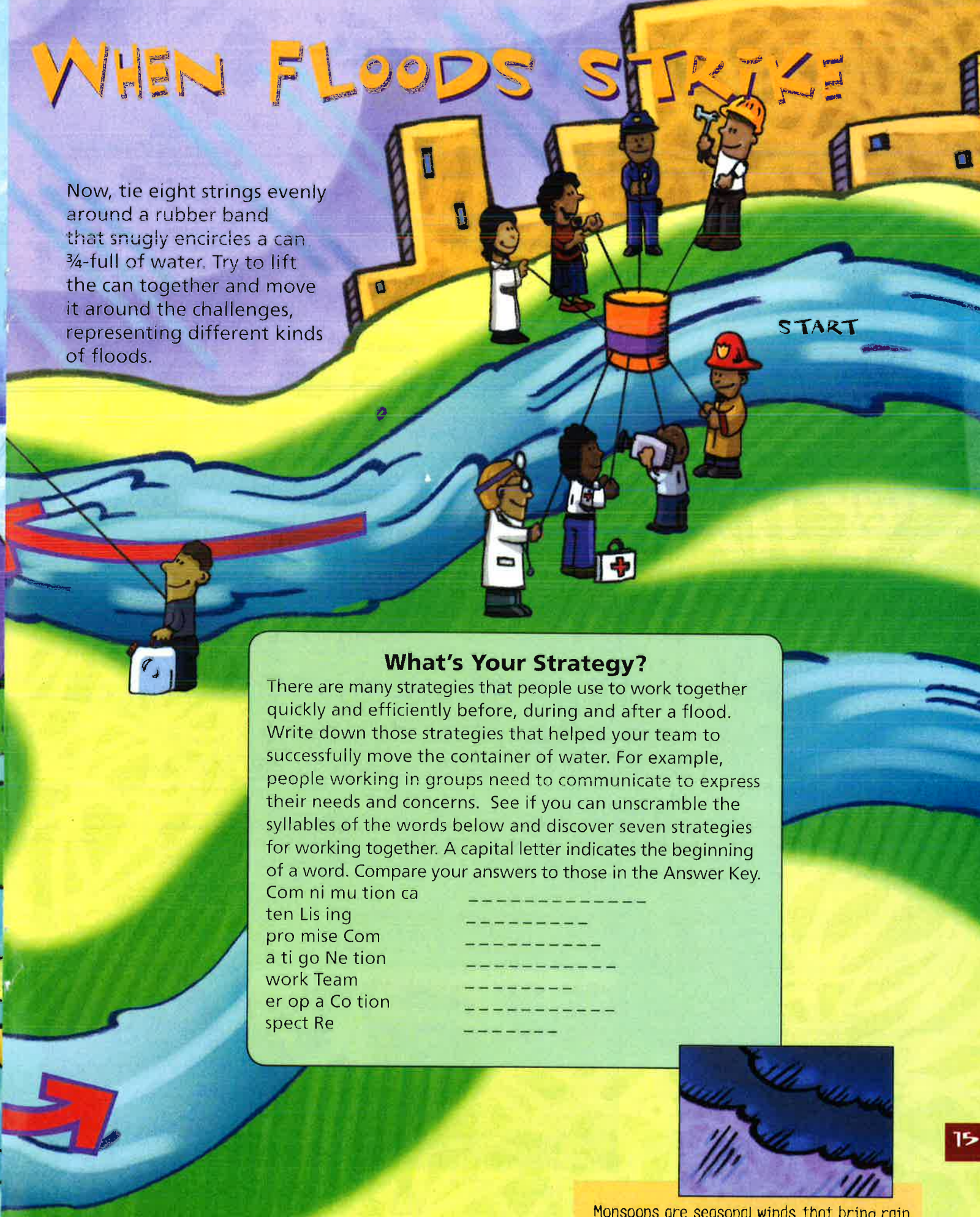

START

What's Your Strategy?

There are many strategies that people use to work together quickly and efficiently before, during and after a flood. Write down those strategies that helped your team to successfully move the container of water. For example, people working in groups need to communicate to express their needs and concerns. See if you can unscramble the syllables of the words below and discover seven strategies for working together. A capital letter indicates the beginning of a word. Compare your answers to those in the Answer Key.

- Com ni mu tion ca _____
- ten Lis ing _____
- pro mise Com _____
- a ti go Ne tion _____
- work Team _____
- er op a Co tion _____
- spect Re _____

Monsoons are seasonal winds that bring rain.
a. T (!) b. F (+)